

# VOKKERO GUARDIAN GUARDIAN SHOW

User Guide

Version 1.0



211493



EN

# ENGLISH

## INFORMATIONS

Document Information	
<b>Title</b>	VOKKERO GUARDIAN
<b>Subtitle</b>	Show
<b>Document type</b>	User Guide
<b>Version</b>	Version 1.0

This document applies to the following products:

Name	Reference
<b>VOKKERO GUARDIAN - Show</b>	From: VO8154AAD / VO8156AAD
<b>VOKKERO GUARDIAN - Configurator</b>	From: VO8118AA
<b>VOKKERO GUARDIAN - Charger</b>	From: VO8139AA



## DISCLAIMER

This document and the use of any information contained therein, is subject to the acceptance of the VOKKERO terms and conditions. They can be downloaded from [www.vokkero.com](http://www.vokkero.com)

VOKKERO makes no warranties based on the accuracy or completeness of the contents of this document and reserves the right to make changes to specifications and product descriptions at any time without notice.

VOKKERO reserves all rights to this document and the information contained herein. Reproduction, use or disclosure to third parties without express permission is strictly prohibited. Copyright © 2016, VOKKERO.

VOKKERO is a registered trademark in the EU and other countris.

## TECHNICAL SUPPORT

### Website

Our website contains a lot of useful information: information on modules and wireless modems, user guides, and configuration software and technical documents which can be accessed 24 hours a day.

If you have technical problems or cannot find the required information in the provided documents, contact our Technical Support on our website: [www.vokkero.com](http://www.vokkero.com). This ensures that your request will be processed as soon as possible.

### Helpful Information when Contacting Technical Support

When contacting Technical Support, please have the following information ready:

- Product type (for example Guadian)
- Firmware version (for example V1.0)
- A clear description of your question or the problem
- A short description of the application

# EU Declaration of Conformity

**WE**

VOGO

101, place Pierre Duhem, Immeuble Les Centuries II

34000 Montpellier, France

+33 (0)4 67 50 03 98

[www.vogo-group.com](http://www.vogo-group.com)

[www.vokkero.com](http://www.vokkero.com)

**Declare that the DoC is issued under our sole responsibility and belongs to the following product:**

Apparatus model/Product: Vokkero GUARDIAN

Type: VO8150AA, VO8152AA, VO8154AA, VO8156AA

**Object of the declaration:**



The object of the declaration described above is in conformity with the relevant Union harmonisation legislation:

**Directive 2014/53/UE (RED)**

**The following harmonised standards and technical specifications have been applied:**

<b>Title:</b>	<b>Date of standard/specification</b>
EN 300 220-2 V3.1.1	2017/02
EN 300 422-1 V2.1.1	2017/01
EN 303 204 V2.1.2	2016/09
EN 300 328 V2.1.1	2016/11
EN 301 489-1 V2.1.1	2016/11
EN 301 489-3 V2.1.0	2016/09
EN 301 489-9 V2.1.0	2016/09
EN 301 489-17 V3.1.1	2016/09
EN 60950-1	2006 +A1:2009+A2:2013+A12 :2011 :2009+A12 :2011
EN 50566	2013
EN 62209-2	2010

The device complies with the requirements of human exposure to radio frequency fields produced by wireless communications devices worn close to the body. The equipment must be attached to the belt with its Beltclip or to the arm via an armband: spacing of 11 mm between the body and the equipment.

March 19th 2020

Pascal Saguin, Senior Vice President

## USE of VOKKERO GUARDIAN in EUROPEAN UNION USAGE RESTRICTIONS

Some countries in the European Union do not allow all the channels available in VOKKERO Guardian. The table below lists the channels for which restrictions exist

Channel	Frequency (MHz)	Radiated power (dBm)	Restriction
EU1	869,525	27	No
EU2	829,750	20	Yes
EU3	830,750	20	Yes
EU4	831,750	20	Yes
EU5	830,250	20	Yes
EU6	831,250	20	Yes
EU7	829,250	20	Yes
EU8	863,500	10	No
EU9	864,500	10	No
EU10	868,300	14	No

No: Usable in all European Community countries without restrictions  
Yes: RESTRICTIONS in some EU countries.

For channels with usage restrictions, refer to appendix 1 (National Implementation) of recommendation ERC / REC 70-03 available on the ECO (European Communication Office) website:  
[https://www.ecodocdb.dk/document/category/ECC\\_Recommendations?status=ACTIVE](https://www.ecodocdb.dk/document/category/ECC_Recommendations?status=ACTIVE)

For the use of GUARDIAN in Europe (outside the EU), please contact customer support: "[www.vokkero.com/Support/Technical Support](http://www.vokkero.com/Support/Technical%20Support)". In the VOKKERO HELPDESK space, log in with your identifiers (or sign up to create your account) to access the support.

# EU Declaration of Conformity

**WE**

VOGO

101, place Pierre Duhem, Immeuble Les Centuries II

34000 Montpellier, France

+33 (0)4 67 50 03 98

[www.vogo-group.com](http://www.vogo-group.com)

[www.vokkero.com](http://www.vokkero.com)

**Declare that the DoC is issued under our sole responsibility and belongs to the following product:**

Apparatus model/Product: Configurator/ Charger + extensions GUARDIAN

Type: VO8118AA, VO8139AA

**Object of the declaration:**



The object of the declaration described above is in conformity with the relevant Union harmonisation legislation:

**Directive 2014/30/UE (CEM)**

**Directive 2014/35/UE (basse tension)**

**The following harmonised standards and technical specifications have been applied:**

**Title:**

**Date of standard/specification**

EN 301 489-1 V2.1.1

2016/11

EN 301 489-3 V2.1.0

2016/09

EN 301 489-9 V2.1.0

2016/09

EN 301 489-17 V3.1.1

2016/09

EN 61000-3-3

2013

EN 61000-3-2

2014

EN 60950-1

2006 +A1 : 2009 + A2 : 2013 + A11 : 2009 + A12 : 2011

Accessories : AC/DC power supply GS60A and GST90A MEANWELL

March 23th 2020

Pascal Saguin, Senior Vice President

## INTRODUCTION

All rights to this manual are the exclusive property of VOKKERO. All rights reserved. Copying this manual (without written permission from the owner) via printing, copying, recording or by any other means, translating this manual (in full or partially) into any other language, including all programming languages, using any electrical, mechanical, magnetic or optical devices, manually or any by other methods, is prohibited.

VOKKERO reserves the right to change the technical specifications or functions of its products, or to cease manufacturing any of its products, or to cease technical support for one of its products without notice in writing and urges its customers to make sure that the information they have is valid.

VOKKERO configuration software and programs are available free of charge in a non-modifiable version. VOKKERO can make no guarantees, including guarantees concerning suitability and applicability for a certain type of application. Under no circumstances can the manufacturer, or the distributor of an VOKKERO program, be held liable for any damage caused by the use of the aforesaid program. Program names, as well as all copyright relating to programs, are the exclusive property of VOKKERO. Any transfer, granting of licences to a third party, leasing, hire, transport, copying, editing, translation, modification into another programming language or reverse engineering are prohibited without VOKKERO's prior written authorisation and consent.

A black rectangular box containing the white text 'EN', indicating the language of the document.

## ENVIRONMENTAL RECOMMENDATIONS

All superfluous packaging materials have been eliminated. We have done everything possible to make it easy to separate the packaging into three types of materials: cardboard (box), expanded polystyrene (filler material) and polyethylene (packets, foam protective sheets). Your device is composed of materials that can be recycled and reused if it is dismantled by a specialist company. Please observe local regulations concerning the manner in which waste packaging material, used batteries and your obsolete equipment are disposed of.

## WARNINGS

Valid for :

VOKKERO GUARDIAN - Show : VO8154AAD / VO8156AAD

VOKKERO GUARDIAN - Configurator : VO8118AA

VOKKERO GUARDIAN - Charger : VO8139AA



Read the instructions in the manual.



The safety of this product is only guaranteed when it is used in accordance with its purpose. Maintenance should only be carried out by qualified persons.

**Please note:** Do not install the equipment close to a heat source or in damp conditions.

**Please note:** When the equipment is open, do not carry out any operations other than the ones set out in this document.



Please note: Do not open the product as there is a risk of electrical shock.



Please note: For your own safety, you must ensure that the equipment is switched off before carrying out any work on it.



Please note: For your own safety, the power supply circuit must be SELV (Safety Extra Low Voltage) and must be from limited power sources.

The product must be equipped with a switching mechanism so that the power can be cut. This must be close to the equipment. Any electrical connection of the product must be equipped with a protection device against voltage spikes and short-circuits.



## DISPOSAL OF WASTE BY USERS IN PRIVATE HOUSEHOLDS WITHIN THE EUROPEAN UNION



This symbol on the product or on its packaging indicates that this product must not be disposed of with your other household waste. Instead, it is your responsibility to dispose of your waste by taking it to a collection point designated for the recycling of electrical and electronic appliances. Separate collection and recycling of your waste at the time of disposal will contribute to conserving natural resources and guarantee recycling that respects the environment and human health. For further information concerning your nearest recycling centre, please contact your nearest local authority/town hall offices, your household waste collection company or the shop where you bought the product

The products only can be used with batteries supplied by VOGO



 Warning: If the charger is used with any other batteries or products whatsoever, there is a risk of an explosion. After use, the batteries must be disposed of at an appropriate recycling centre. They must not be thrown away to degrade in the environment. When batteries are replaced, the device must be correctly implemented.



Warning for Switzerland : the annex 4.10 of SR 814.013 Standard must be applied for batteries.

This symbol on the device or its packaging means the use of a DC voltage.



## RECOMMENDATIONS REGARDING USE FOR VO8118AA & VO8139AA

- Before using the system, check that the power supply voltage shown in the user manual corresponds to your supply. If it doesn't, please consult your supplier.
- Place the device against a flat, firm and stable surface.
- The device must be installed in a location that is sufficiently ventilated so that there is no risk of internal heating and it must not be covered with objects such as newspapers, cloths, curtains, etc.
- The device must never be exposed to heat sources such as heating equipment.
- Do not place the device close to objects with naked flames such as lit candles, blowtorches, etc.
- The device must not be exposed to harsh chemical agents or solvents likely to damage the plastic or corrode the metal parts.
- The device must be attached to belt with the belt-clip.

## INTRODUCTION

The operations described below allow you to rapidly and easily implement your VOKKERO Guardian communication system.

All the operations described are valid for all the VOKKERO® Guardian terminals listed below:

VOKKERO GUARDIAN - Show : VO8154AAD / VO8156AAD

Note: Your product reference is given on the label on the back of the terminal housing.

The VOKKERO Guardian system is ready-to-use; it features the following three main elements:

Terminals

Configurator/Charger: VOKKERO GUARDIAN - Configurator : VO8118AA

(Optional) Charger extension (1 to 4 maximum): VOKKERO GUARDIAN - Charger : VO8139AA

All the operating settings of the VOKKERO Guardian system are managed by the configurator which gives access to the Settings menu via a touchscreen. The configurator must be connected to the power supply (otherwise it will not work) and up to 4 extensions units can be chained with the configurator.

## 1. SYSTEM INSTALLATION PROCEDURE

Connect the power supply to the configurator or at the back of last chained charging unit if several are connected in a row.

Connect the power supply to the mains.

Insert the VOKKERO Guardian terminals in each slot as shown below.

Note 1: the position of each terminal in each particular charging slot has no influence on the nature of the configuration, except for Slot 1 (refer to §3.2)

Note 2: if the purpose of the operation is solely to charge terminals or spare batteries, the use of extension unit only is fine.



The first configurator slot (i.e., closest to the LCD) is of importance to the system-configuration process; for more details, refer to §3.2.

## 2. SYSTEM DESCRIPTION

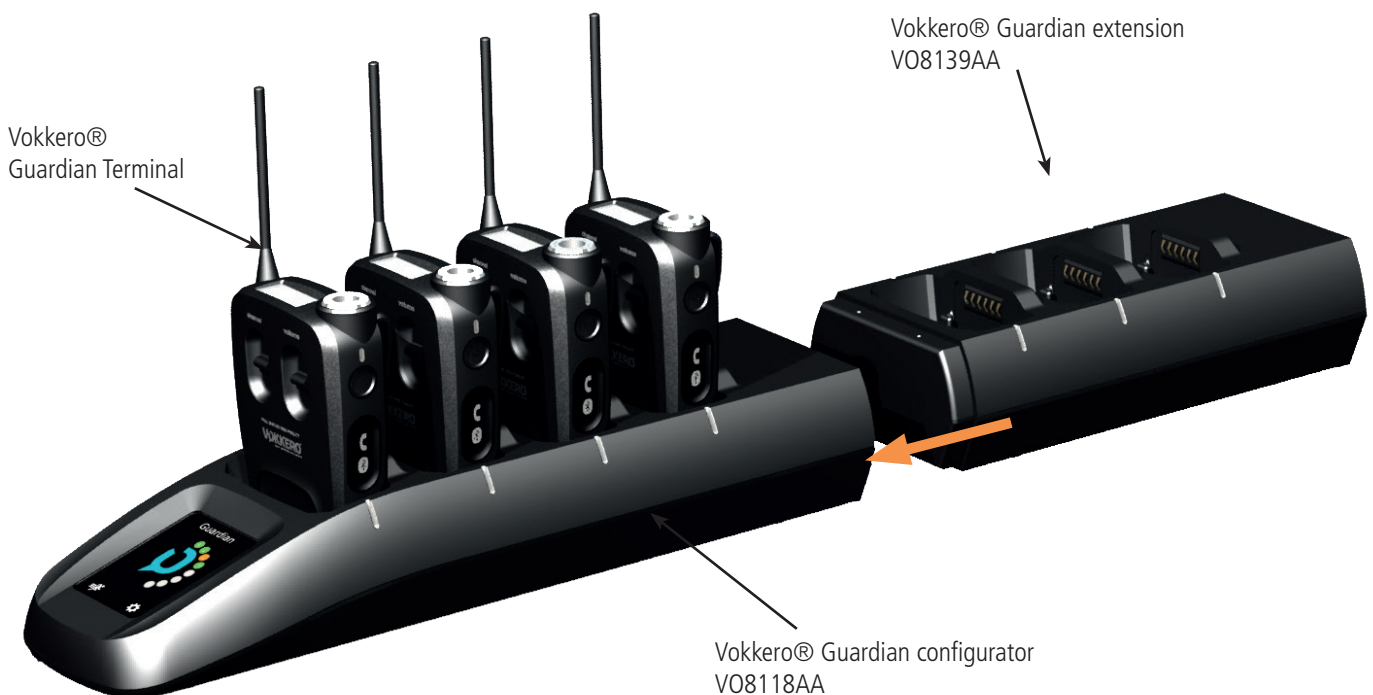

## 2.1. VOKKERO® Guardian Terminal

### 2.1.1. Description of product interface

### 2.1.2. General characteristics



General Specifications	Value
Supply voltage	3.7V nominal
Maximum consumption	800mA (emission)
Terminal power supply	Lithium battery
Battery life	11 hours (normal usage) 7 hours (permanent communication) If Bluetooth option activated, then 10% drop in battery life
Operating temperature	-20°C / +55°C
Dimensions	110 x 70 x 27mm
Weight	190g (including battery)

## 2.2. VOKKERO® Guardian Charger/Configurator

### 2.2.1. Description of product interface



### 2.2.2. General Technical Specifications

Specifications	Value
AC/DC Power Converter (standard)	100 to 240V 12VDC/5A - 50/60Hz (maximum of 10 terminals charging)
AC/DC power converter (extended system)	100 to 240V, 12 VDC/6.67A - 50/60Hz (more than 10 terminals charging)
Operating temperature	-5°C / +40°C
Dimensions Configurator/Charger	337 x 95 x 58mm
Dimension extension	216 x 95 58mm
Weight configurator/charger	470g
Weight extension	310g

### 3. STARTING UP THE TERMINAL

Before starting your terminal, make sure that it has been properly charged using a compatible charger.



Press the On/Off button to turn on the terminal.

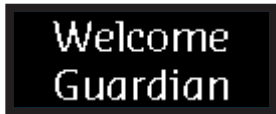

The LCD screen should turn on and display the VOKKERO® logo. The LED above the On/off button should also light up permanently.

Next, the Welcome Screen displays, followed by the product user's name. By default, user name is "Guardian". Name can be customized in the configurator for each terminal (refer to §4.3.1). To turn off the terminal, press and hold the "on/off" button.

Note 1: all settings, including volume, are saved when switching terminal OFF.

Note 2: When LCD screen is set in Sleep Mode, to switch the On Off button when terminal is On (with sleeping LCD) will wake up the backlit LCD. To switch Off the unit, press On Off button a second time.

#### 3.1. LCD Screen Icons (by Default)

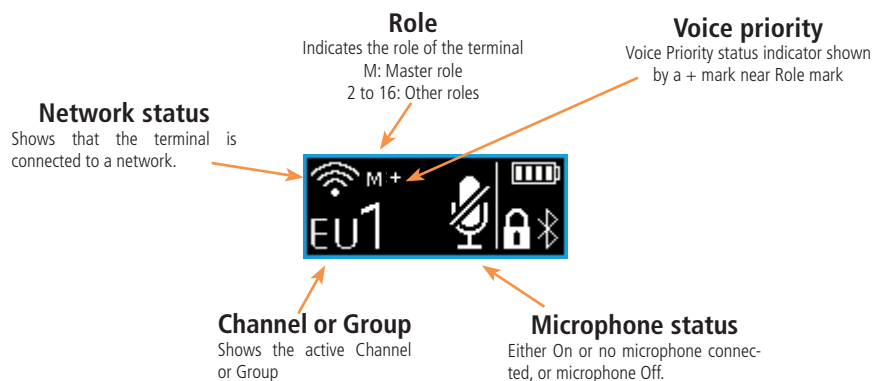

#### 3.2. IMPORTANT: about M role

When setting up your Guardian Show system, the first step consists in attributing the Master role (M) to a single terminal of your choice. This M role is crucial to synchronize the digital communication between every beltpack of the system.

The Master role (M) is automatically attributed to the terminal located in the configurator's slot n°1 when doing a Quick Configuration (See 4.2).

Note that Guardian Show system allows one M only in service, in order to perform normally. To attribute and operate more than one M at a time will corrupt the entire system radio performance.

If you wish to use more terminals than your configurator's slot capacity, or while terminals are already in operation, make sure to always leave Slot n°1 free (empty) and use Fixed Key function (see 4.3.2)

EN

### 3.3. Headset connection

Several types of headsets of the VOKKERO range can be connected to VOKKERO Guardian SHOW. The headset type is automatically detected by the terminal when connected.

#### 3.3.1. Plugging in a headset

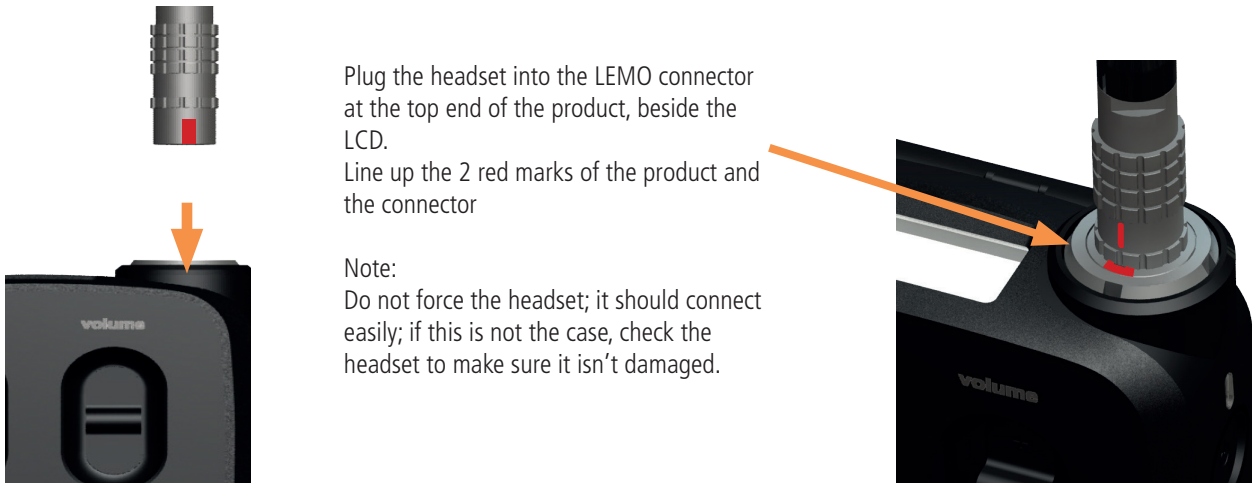

#### 3.3.2. Removing the headset

Pull on the ring of the headset to release the connector switch and pull out the Lemo connector

- Do not attempt to remove the headset by pulling or twisting or turning the connector's chassis.



Use the "Mic" icon on the terminal screen to make sure that the headset is properly connected. After disconnection of a headset, it is necessary to wait a few moments for the mic icon to be crossed out before reconnecting a headset.



### 3.4. Terminal operation

#### 3.4.1. Volume

Adjust the terminal volume with the Volume trigger button.  
 Push the trigger upwards to increase the volume  
 Push the trigger downwards to decrease the volume

When you increase or decrease the volume, you will hear a beep.  
 When you reach the maximum or minimum volume setting, you will hear 2 consecutive beeps.  
 The volume setting is also indicated on the terminal LCD.  
 The sound level can be adjusted between 0 and 10. When level 8 is reached, an alert message is displayed on the terminal screen («Warning: high volume. Consult User Guide»).

#### 3.4.2. Channel (activated mode by default)

Adjust the terminal's communication channel with the Channel trigger button.  
 Push the trigger upwards to increase the channel number  
 Push the trigger downwards to decrease the channel number  
 The channels available on the terminal depend on the terminal version; for more information, refer to the channels table (document annex).

When you change channel, you will hear a beep.  
 When you reach the top or bottom channel, you will hear 2 consecutive beeps.  
 The selected channel is also indicated on the terminal LCD.

#### 3.4.3. Group (accessible when configured)

To change groups, you must also use the Channel trigger button:  
 Push the trigger up to increase the group number  
 Push the trigger down to lower the group number

VOKKERO® Guardian SHOW feature 3 groups in addition of Group 0 (zero).  
 Group 0 links all groups.  
 Thus, the terminals in groups 1 to 4 can only hear and speak with the members of their group. Group 0 terminals (Gr0) can hear and speak with all groups.

When you change groups, a beep in the accessory's loudspeaker signals that the terminal has taken the change of group into account.  
 A double beep signals that you have reached the upper or lower limit.

Check the number of the selected group on the terminal's LCD.

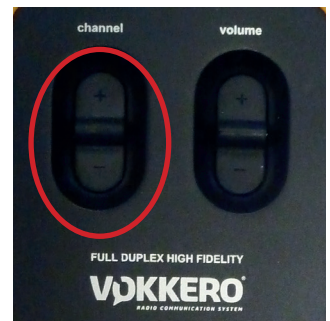

### 3.4.4. "Mute" button

Adjust the Microphone On / Off by using the Micro button.

The Mute button can be configured in various modes using the configurator or directly from terminal's onboard menu; for full information on available modes, refer to §4.3.1.

Check the microphone status on the terminal LCD:

if there is a Struck-through micro icon, then the microphone is Off and you can not be heard on the network.

if there is no Struck-through micro icon, then the microphone is On and you can be heard on the network.



### 3.4.5. Call button

Use the Call button to send an alert to all the terminals on the network or on the corresponding group(s).

When calling, every terminal screen displays the "Call" icon, together with the call sender's name.

Note: if the "GROUP" function is active, then the notification is only sent to group of which the call sender belongs, in addition to Group 0.



### 3.4.6. Bluetooth (Option)

The Bluetooth function is used to send and make phone calls whilst remaining on the work device. This function can also be used to connect a Bluetooth wireless headset.

You can only pair one Bluetooth device per terminal; reconnection takes place automatically on restarting the terminal.

Pairing with a mobile phone:

Open the Bluetooth device manager on your mobile phone (if necessary, consult the user guide of your mobile phone for more information on connecting a Bluetooth-enabled device).

As soon as your mobile phone is ready to detect new devices, press and hold the Bluetooth key of the VOKKERO Guardian terminal; the indication "Guardian Pairing" should display on the LCD screen.



EN



You should see a new Bluetooth device with the name of your terminal (Guardian, by default) on your mobile phone.

Select this device to terminate pairing.

**Pairing with a Bluetooth headset:**

Start the pairing mode of your headset (if necessary, consult the user guide).  
 As soon as your headset is ready to detect a new device, press and hold the Bluetooth key of the VOKKERO Guardian terminal.  
 Complete the pairing by following the procedure of your Bluetooth headset.

As soon as the pairing has been completed, the Bluetooth icon displays on the screen of your terminal; you can now send and receive phone calls via your terminal.



**Phone call**

To make a call from your mobile phone, you use the telephone interface (consult the User guide of your mobile phone for more information). It is not unusual to have to select "Bluetooth headset" on your mobile phone in order to switch the audio communication to the Bluetooth device.  
 During a phone call, the terminal's LCD screen displays a blinking icon for the duration of the call.

**Receiving a phone call**

Si vous recevez un appel téléphonique, le terminal vibre et un double bip est émis dans l'accessoire micro-casque.  
 To answer the call, press the Bluetooth button.  
 To end the call, press the Bluetooth button.  
 During the phone call, the terminal's LCD screen displays a blinking icon for the duration of the call.



**Switching between Smart Phone/Audio Conference**

You can be using the terminal as a mobile phone and switch back to an ongoing audio conference by pressing the Bluetooth button twice.  
 Press the button again to return to your phone call.

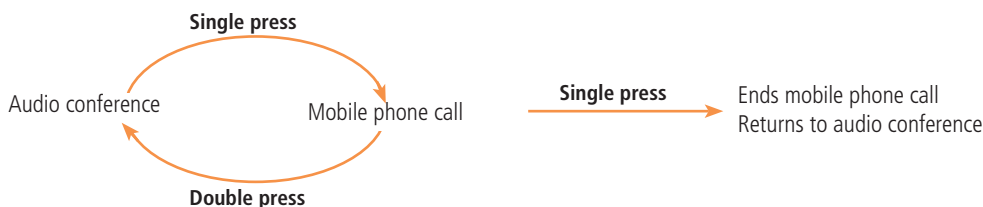

**Ending a phone call**

To end a phone call, press once on the Bluetooth button.

EN

### 3.4.7. Battery

The terminal's battery can be removed and recharged on the charger.

#### Removing the battery

Remove the battery from the terminal by pressing the locking mechanism at the top of the terminal and then slide the battery downwards.

#### Inserting the battery

Slide in the battery at the back of the product; keep pushing until you hear the locking clip.



### 3.4.8. Belt clip

#### Removing the belt clip

The terminal comes with a belt clip. However, you can remove this; simply take out the battery, pull on the locking mechanism in the center of the belt clip, and then slide it downwards.

#### Attaching the belt clip

Slide the belt clip into the slot; keep pushing until you hear the locking clip.

NOTE : the terminal must always be positioned at the belt using the clip provided or on the arm via a armband ensuring a distance of 11mm from the body.



## 4. TERMINAL MENU AND SETTINGS

### 4.1. Basics

Audio, Radio and System Functions can be adjusted directly from a simple menu onboard every terminal

To enter Menu, press and hold Channel trigger center switch.

To exit Menu, press and hold Channel trigger center switch or wait 5 seconds.

To browse Menu functions, lift Channel trigger up or down.

To adjust function's parameters, lift Volume trigger up or down.

Adjusting parameters don't need a specific action of validation to be activated; the parameter in use is the parameter shown on the display screen.

### 4.2. Functions description

#### 4.2.1. Lock

Set Lock function ON to lock all terminal commands except for the headset Volume adjust and Menu access.

When Lock function is set ON, the menu is automatically exit.

To unlock the terminal, get back in the Menu by holding Channel trigger center switch, and adjust Lock to OFF position.

#### 4.2.2. Gate Level

Adjust the mic gate between 3 gate levels: Soft, Mid et Hard (+ Off).

Soft gate being recommended for quiet environment or in the case Voice Detector is activated (see Voice Detector), Hard gate being recommended for noisy applications.

Note that Gate Adjust is not available in Rigging Mode (see chapter 7)

Note that Gate cannot be set to OFF in Live Mode (see chapter 7)

Note that when adjusting Gate level, Side Tone is momentarily activated (Post-Gate) providing a clear feedback when searching for the most appropriate gate level.

#### 4.2.3. Side Tone

Adjust the Side Tone between 3 different levels.

Side Tone can be heard only when Mic is activated (Latch or PTT)

At maximum Side Tone level, some external noises may be heard.

#### 4.2.4. Voice Detector

The Voice Activity Detector (VAD) is a selective algorithm that allows to communicate in extremely noisy environment. By opening the microphone path only when human voice is detected, the algorithm avoids loud noises to pass through coms. One big advantage of the VAD is to keep hands free while trussing and stage rigging.

Note that the activation of VAD may generate extra latency.

Note that VAD is OFF by default except for Rigging Mode (always ON).

#### 4.2.5. Voice Priority

One terminal of the system can be set from the Configurator Menu as the « Voice Priority » terminal. When Voice Priority is on, any order from that particular beltpack will take over priority over the full duplex system, while incoming audio from other beltpacks is decreased of -12dB.

Note that Voice Priority function is only available for one terminal of the conference.

Voice Priority settings does not appear on other terminals Menu (if not set from the configurator).

When Voice Priority is active, the display LCD screen shows a '+' near by the Role Indicator mark.

#### 4.2.6. Max RF Power

Adjust the RF power here.

Note that depending on the frequency in use, maximum RF power may vary between 500mW and 10mW, and therefore some frequencies feature less adjustment steps, in accordance with regulatory requirements (see page 5).

#### 4.2.7. PTT Mode

Choose between Latch, PTT and Latch + PTT.

Each beltpack can be individually set as PTT, Latch, or PTT+Latch modes.

In PTT+Latch mode, a short push on the Mute button engages Latch (hands free – mic on) and another short push mutes the mic, while a long push engages PTT and the release of the button mutes the mic.

Note that default setting is Latch for Rigging mode and PTT for Live and Studio modes.

Note that when using Live and Studio modes, to set more than two terminals with Latch may input too much ambient noise into the system.

#### 4.2.8. LCD

Choose between Always ON and Sleep.

When Sleep mode is selected, LCD lites off 3 seconds after last command is used.

The LCD wakes up when a function is manipulated. To light up the screen for status check only, simply press Power On button.

Note that Sleep also engages the Flashlight call mode (LCD flashes when receiving call).

#### 4.2.9. Call Mode

Select between Bip + Vibrator, Vibrator only or Silent.

Note that each Performance Mode (Rigging, Live and Studio) has its own preset.

#### 4.2.10. Listener Mode

When ON, this mode deactivates Mic.

## 5. DESCRIPTION OF THE CONFIGURATOR

The configurator does not have an On-Off switch. To turn it on, the configurator must be connected to the power unit provided with the VOKKERO Guardian. The configurator has a USB port for software updates. The configurator screen is a high-resistance touchscreen.

The configurator can also be used to download products.

Immediately upon starting up the system, the configurator displays the VOKKERO logo, with the firmware version of the configurator, followed by the Home Screen.

### 5.1. Home Screen

The screen indicates the number of terminals that the configurator can hold (each number corresponds to one terminal). The configurator uses a color code to indicate the terminal's charging status or the battery's charging status, using the following code: If red icon, then the terminals placed on the configurator have not been correctly configured to work together;



- Empty space
- Terminal in charge
- Terminal loaded
- Terminal battery fault
- Battery in charge
- Battery loaded
- Battery in error

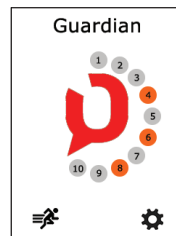

A "WI" icon displays when you connect the optional WI interface on the configurator.



You can rapidly configure the entire system by selecting the RUNNER icon. Alternatively, you can fine-tune the system configuration by using the settings icon.

You can also proceed directly to the configuration of the terminal by selecting the desired terminal number.

## 6. QUICK CONFIGURATION

Quick Configuration must be operated before first use, and it is recommended to renew a Quick Configuration each time the system is used in a new location or environment.

The Quick Configuration enables the communication of every terminal, using similar encryption key and sync clock as soon as the Master terminal (M) is turned ON.

A Quick Configuration is operated in 3 steps: Selection of Performance Mode, Channel restriction (Sports Arena) and Channel selection.

### 6.1. Quick Settings / Performance Modes

A choice between 3 different Performance Modes is given during the Quick Configuration initial phase: Rigging mode, Live mode and Studio mode. Parameters of each preset can be individually adjusted afterwards.

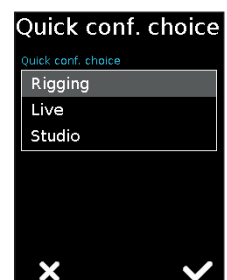
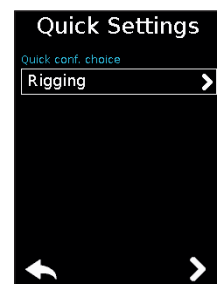

EN

### 6.2. Mandatory Channel Restriction during Sport Events

If you perform in a sport arena during a sport event, make sure you select YES to the question « Do you perform during a sport event ».

This action will prevent from using similar frequencies as referees come on the pitch.

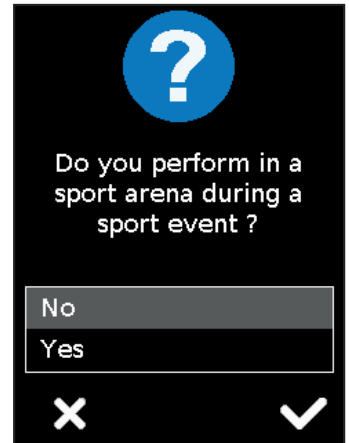

### 6.3. Channel Selection

Browse in the channel menu and select your preferred channel here.

Confirm by ticking the box.

Start the configuration by selecting "GO" on the screen, and then validating the confirmation screen; the configuration starts.

If the configuration completes successfully, the indication "DONE" displays. Alternatively, the indication "ERROR" displays if a problem is encountered.

To return to the Home Screen, use the left arrow.

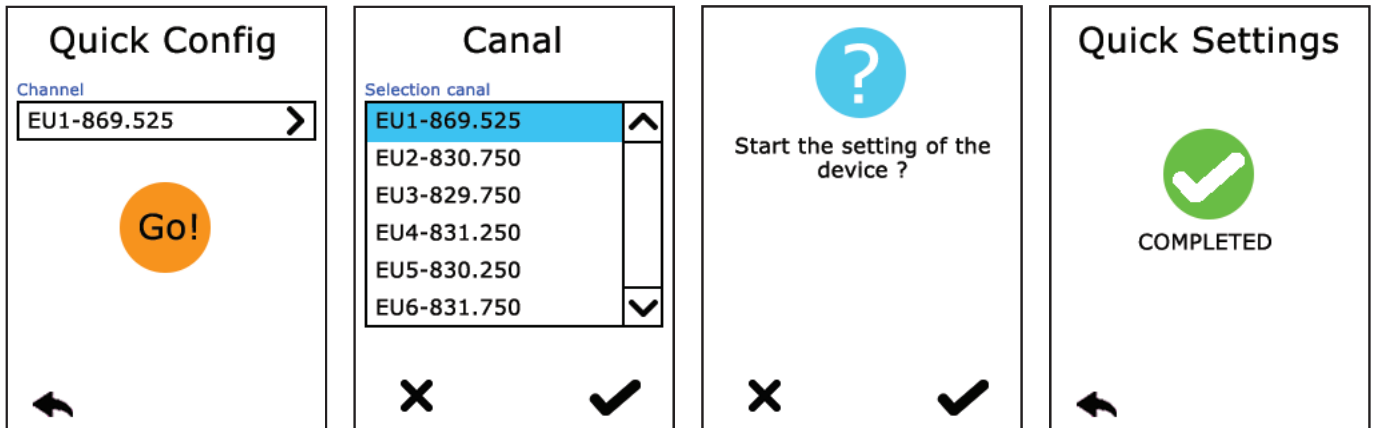

EN

## 7. PERFORMANCE MODES

GUARDIAN SHOW features 3 different radio and audio presets (Rigging, Live, Studio), in order to comply with a great variety of use cases, from a noisy stage building environment to the quietness of a studio set.

Select the Performance Mode of your choice when doing the Quick Configuration of the system, as described in 6.1.

**Studio :**

Ideal for video productions or quiet environments such as theatres  
 (Sharp latency, PTT Mode, Voice Activity Detector OFF, gate level off, 7 users max including a potential Wireless Interface)

**Live :**

Ideal for live coms with cues (Go) and descending orders from director to technicians  
 (Ideal latency, PTT Mode, Voice Activity Detector OFF, Hard gate level, Unlimited users)

**Rigging :**

Ideal for stage trussing and fixture mounting in noisy environments  
 (Basic latency, Latch mode (hands-free), Voice Activity Detector ON, Normal gate level, Unlimited users)

	RIGGING	LIVE	STUDIO
Latency	Basic	Ideal	Sharp
PTT Mode	Latch	PTT	PTT
Gate Level	Soft	Hard	OFF
VAD (voice detection)	YES	No	No
Side Tone	On	On	On
Call Mode	Bip + Vibrator	Bip + Vibrator	Vibrator
Users	Unlimited	Unlimited	6 + Wi



## 8. TERMINAL CONFIGURATION



This screen indicates the terminals present on the configurator. The charge status as well as the name of each terminal displays. The terminals display in their order of presence on the configurator, going from the closest (position 1) to the furthest away.

To modify a product, select the product row; this displays all the settings available for the selected product.

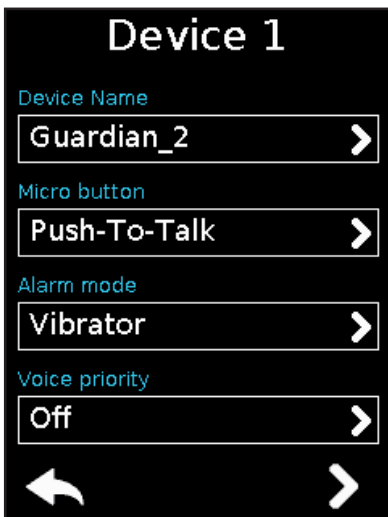

The available settings are as follows:

- Terminal name (1): product name displayed on the LCD
- Microphone action (2): defines the behavior of the audio button in the middle of the terminal
- Alarm mode (3): defines the operating mode of the alarm
- Voice Priority
- Advanced Settings (5): Provides access to the following options: Assignment buttons, Alarm button, Expert mode
- Version (6)
- Factory Setting (7): allows to reset the products to factory settings

### 1 - Terminal name

To change the name of the terminal, you can use the available keyboard. Three screens/keyboards are available to de-fine the product name. To switch between screens/keyboards, use the button on the bottom right-hand side.

- "abc" to switch to the lowercase words screen
- "123" to switch to the numbers and symbols screen
- "ABC" to switch to the uppercase words screen

Use to delete the most recently entered character.

To validate, select on the bottom right-hand side.

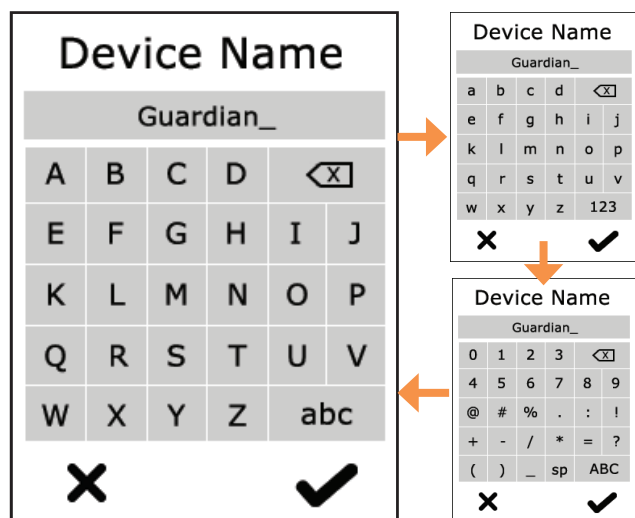



## 2 - Microphone action

The central button can have a number of operating modes:

- Latch: press to switch the microphone from Microphone On to Microphone Off; the microphone status displays on the terminal LCD
  - Push to talk: the microphone is On for as long as the button is pushed and held.
  - To note: it is implemented a latency of a second at the closing of the microphone after release of the button. This avoids any audio interruptions even with unwanted release of the pressing of the button during a conversation.
  - Latch /Push-To-Talk: combination of Latch and Push-to-Talk functions
- A short press switches from Microphone On to Microphone Off.  
 If the microphone is Off, press and hold this button to switch to Microphone On.
- Push to mute: The microphone is Off for as long as the button is pushed and held



## 3 - Alarm Mode

Whenever the product receives a call from another terminal or from a paired Bluetooth device, it can notify the user depending on the configured mode. The modes available are:

Silent: Flashing screen only

Vibration: the terminal vibrates + visual notification on LCD

Audio + Vibration: combined action: sound beep + vibration + visual notification on LCD

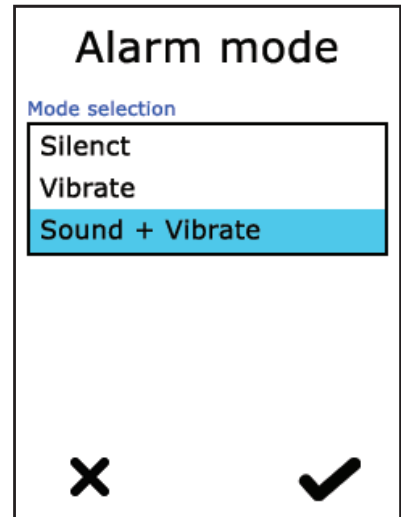

## 4 - Voice Priority

Select here which terminal will get benefits of the Voice Priority function.

One beltpack of the system can be set as the « Voice Priority » beltpack. When Voice Priority is on, any order from that particular beltpack will take over priority over the full duplex system, while incoming audio from other beltpacks is decreased of -20dB.

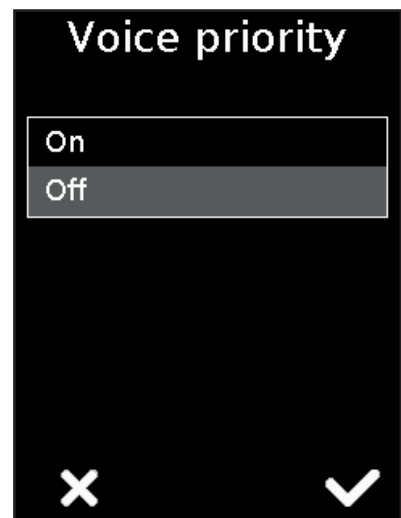

## 5- Advanced settings

Provides access to the following options:

- Assign buttons: to change the functions of the buttons on the terminal
- Alarm button: to change the press mode of the alarm button
- Expert mode: Users cannot access this mode as it has settings that can disrupt the smooth-running of your VOKKERO® Guardian system.

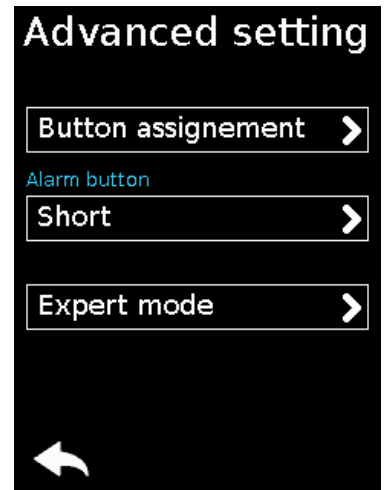

### 5.1 Button assignment

Reset the functions of the terminal buttons or disable certain functions.

The microphone On / Off + Call + Bluetooth buttons can be switched or deactivated. Click the option shown by the pictogram on the button of your choice and reassign the chosen function to it.

The Channel and Volume Selector triggers can only be turned on or off.

To reset the original functions, reload the terminal's default settings via the «Factory Setup» menu.

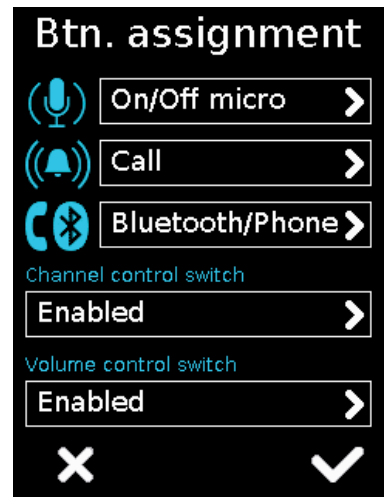

### 5.2 Alarm button

Allows you to change the way you press the «Call» button to activate the alarm, regardless of the selected alarm mode (silencer, vibrator or sound + vibrator).

The possible ways of activating the alarm are:

- Short: 1 short press on the Call button triggers the alarm
- Long: 1 long press on the Call button triggers the alarm
- Long + Acknowledgment: 1 long press on the Call button triggers a loop alarm. To stop the alarm, press again continuously on the same button from one of the network terminals.

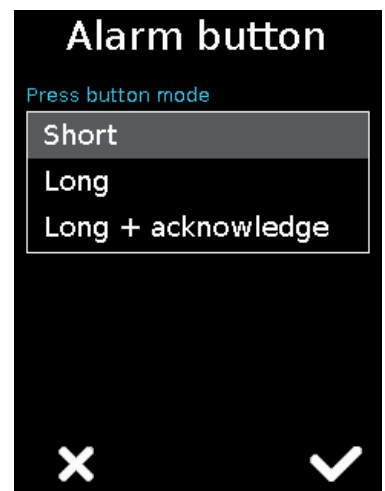

EN

### 6 - Version

Shows you the factory version of the terminal used.

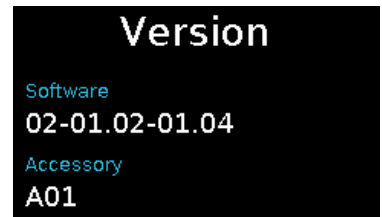

### 7 - Factory settings

This menu returns, to the factory setting, a product or all products connected to the configurator. After selecting and validating your choice, the configurator lets you know if the return to factory settings completed successfully.

To finalize the operation, select the arrow on the bottom left-hand side to return to the configuration screen of the terminals.

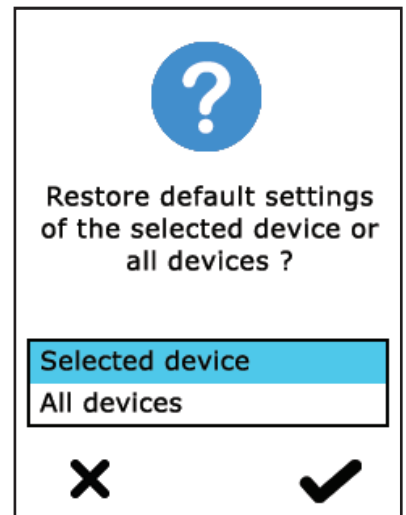
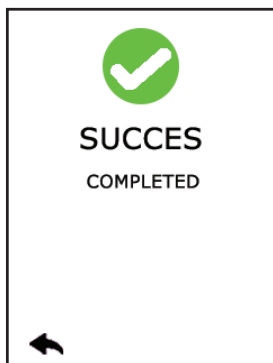

## 9. SYSTEM CONFIGURATION

In this screen you can see all the settings related to the system configuration. The settings in this menu apply to all the terminals present on the configurator.

The available settings are:

- Group Mode: Enables or disables group mode
- Encryption: allows you to choose the encryption operating-mode
- Software: allows you to update the software version of the terminals and configurator

### 9.1. Group mode

Use this setting to activate and deactivate the Group mode.

When activated, the system operates under Group mode on a fixed frequency; use the Channel trigger to switch between groups.

After a Quick Configuration, every terminals are set in the same group (group 0).

Details of groups:

Group 0 (Gr0): you can hear and talk with all groups.

Group 1 to 3: you can only hear and talk with members of that group, in addition of the members of Group 0.

### 9.2. Encryption

The encryption key is used to make communications within a given system secure. Only the devices using the same encryption key are authorized to communicate on the network.

Several options are available:

No encryption: the communications are not secure; all the Guardian devices can join the network, even if they have no encryption key.

Single key: the system uses one single encryption key; this key can be occasionally changed by the user by selecting "New Key"

New Key with each configuration: the configurator generates a new key with each new successfully performed con-figuration.

### 9.3. Software Update

Use this sub menu to update the software versions of the terminals and / or the configurator.

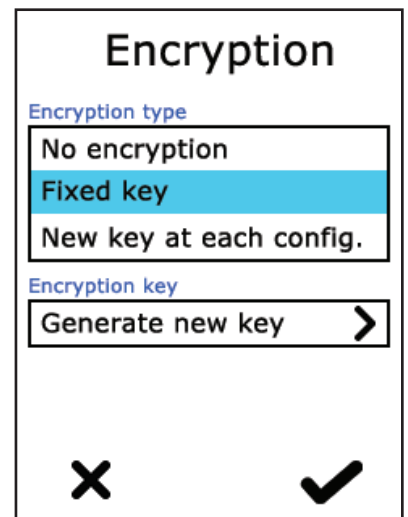
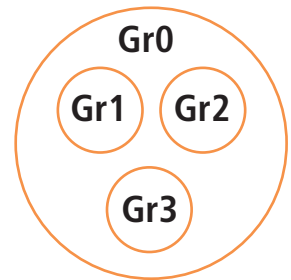
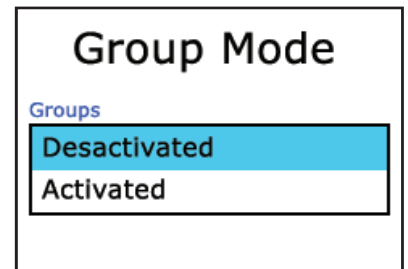
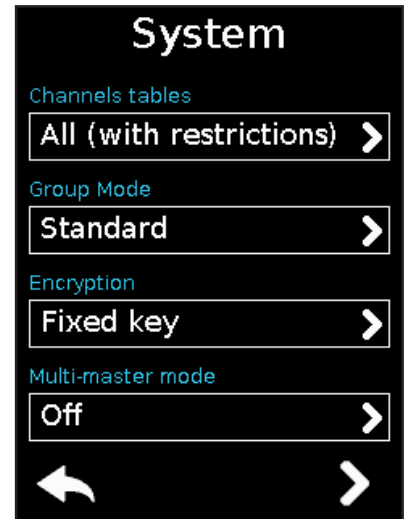

EN

## 10. SOFTWARE UPDATES

### 10.1. Terminal software update

To update terminals you have to use a USB key.  
Contact your vendor to obtain the most recent software version.

The USB key used must be < or = 4Go.

On the USB key:

- Copy the update software to the root
- The files mustn't be in a folder
- No others files or folder have to be on the USB key

To know the version currently installed in the terminal:

Menu > System > Software > Device update:

The version currently installed in the terminal appear on the display. (Screen No. 1).

To configure a new software version on the terminals:

Once the USB key ready, insert it into the dedicated USB port, situated on the left located on the left side of the configurator. (Screen No. 2)

Once the USB key connected, the available software version is displayed. (Screen No. 3)

(If the USB key is empty or involves wrongs files, you will read on the display: «Update file missing from the USB key»)

Click «GO» to validate. (Screen No. 3)

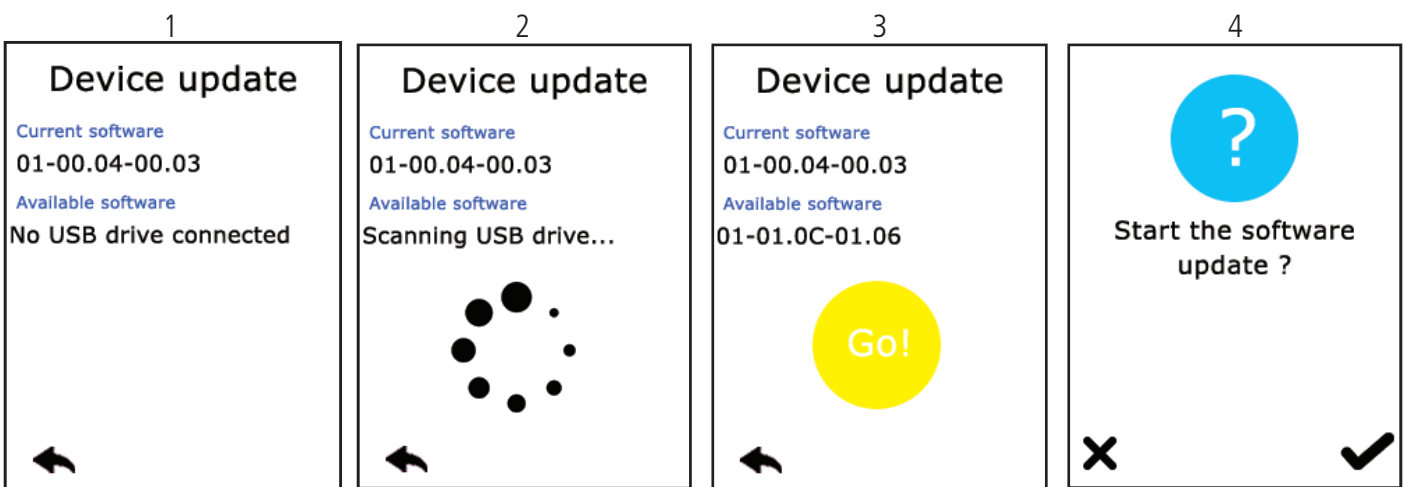

Then, click ✓ to launch the installation. (Screen No. 4)

The update of the terminals is launched (Screen No. 5).

The update is finished (Screen No. 6).

Note: All terminals on the Configurator will be updated regardless of their location on the Configurator.

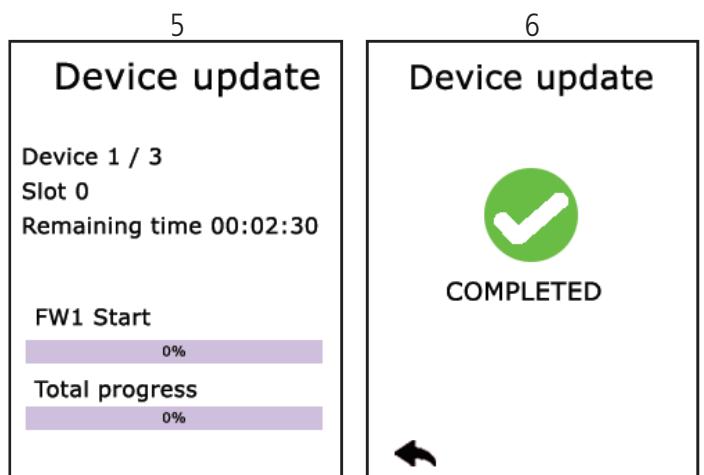

### 11.1. Configurator Update

To update the configurator you have to use a USB key.  
Contact your vendor to obtain the most recent software version.

The USB key used must be < or = 4Go.

On the USB key:

- Copy the update software to the root
- The files mustn't be in a folder
- No others files or folder have to be on the USB key

To know the version currently installed in the configurator:

EN

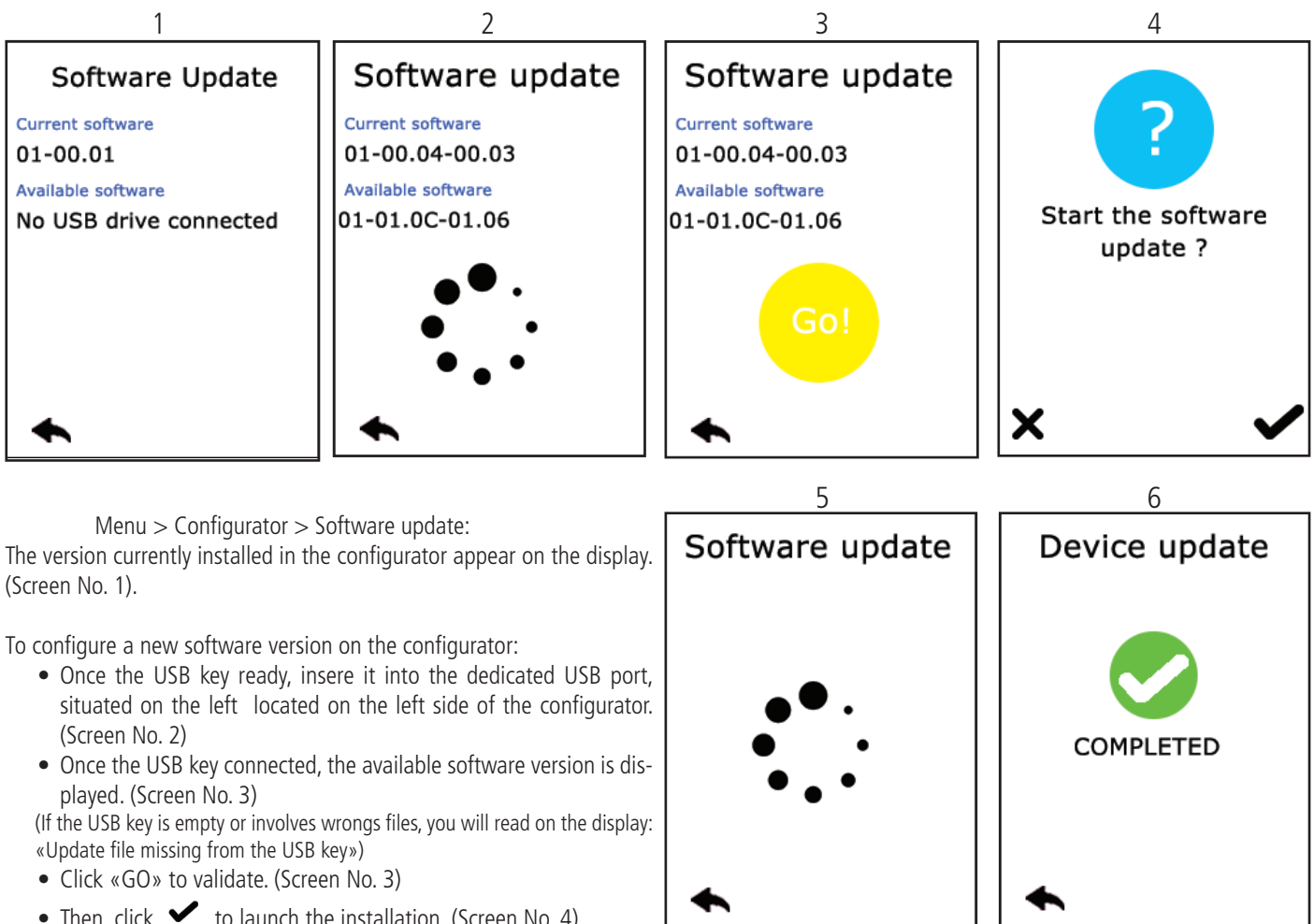

Menu > Configurator > Software update:  
The version currently installed in the configurator appear on the display. (Screen No. 1).

To configure a new software version on the configurator:

- Once the USB key ready, insert it into the dedicated USB port, situated on the left located on the left side of the configurator. (Screen No. 2)
- Once the USB key connected, the available software version is displayed. (Screen No. 3)

(If the USB key is empty or involves wrongs files, you will read on the display: «Update file missing from the USB key»)

- Click «GO» to validate. (Screen No. 3)
- Then, click  to launch the installation. (Screen No. 4)

• The update of the configurator is launched (Screen No. 5).

• The update is finished (Screen No. 6).

## 11. CONFIGURATOR CALIBRATION, LOCK AND RESET

Use this setting to adjust the screen.

In this area, you can adjust the screen lighting, calibrate the touchscreen, and lock the configurator.

### 1 - Adjusting the screen lighting

Slide the cursor from left and right to decrease and increase, respectively, screen lighting.

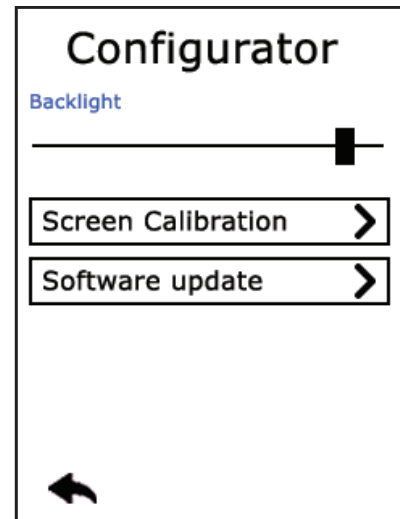

### 2 - Calibrating the touchscreen

The configurator touchscreen is already calibrated in the factory; you can however calibrate your own touchscreen if you note a significant change in screen detection.

To do this, carry out the following 5 steps:

Select each angle with the yellow pointer, then select the circle at the middle of the screen.

The calibration is complete.

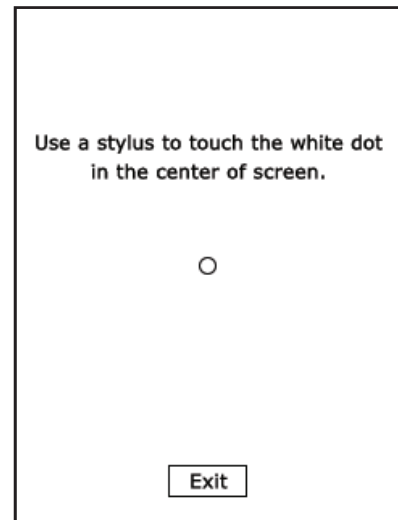
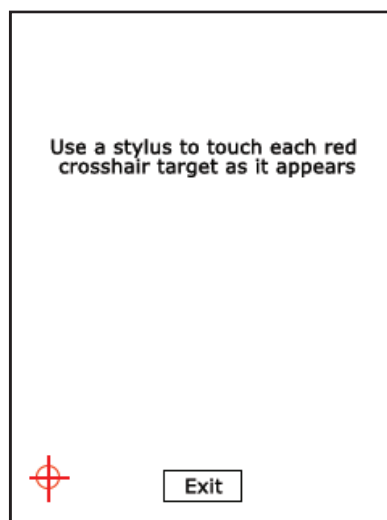
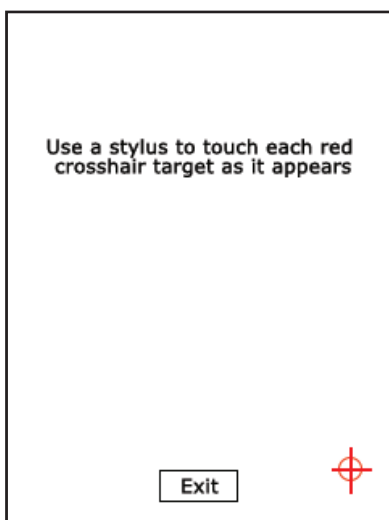
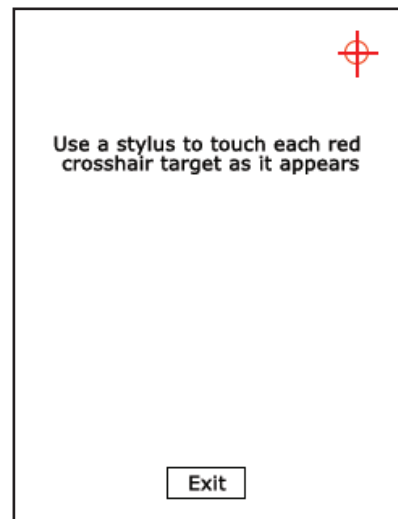
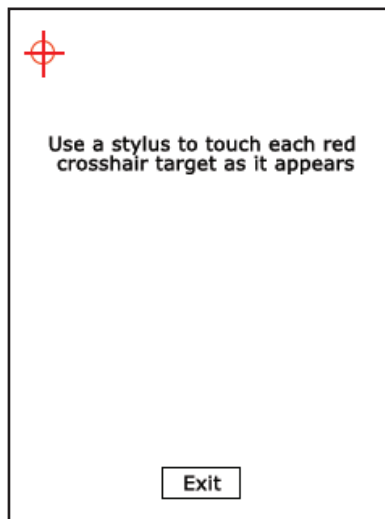

### 3 - Locking

Allows you to block access to the configurator using a PIN code.  
In Lock mode, only the «Quick Config» option is available. You can only access the other settings after validating the PIN code.

Note: The PIN code consists of 1 to 6 digits

Once the lock has been activated, the PIN code can be modified or deactivated (see screen below showing the options available in the «Lock» menu, once the lock has been activated).



### 3- Resetting the configurator functions

In order to put the configurator back in factory mode (and thus cancel all the configuration changes made previously), do the following:

- Unplug the configurator
- Reconnect the configurator
- When the configurator is switched on, on the first home screen, consisting of the «VOKKERO®» logo: press the 2nd «O” of VOKKERO®.
- Then you can restore the default settings of the configurato
- Confirm
- The configurator parameters have been reset.

#### DOCUMENT HISTORY

Version	Contents
V1.0	Creation