

21080 Microphone Stand
21080.300.87 gray

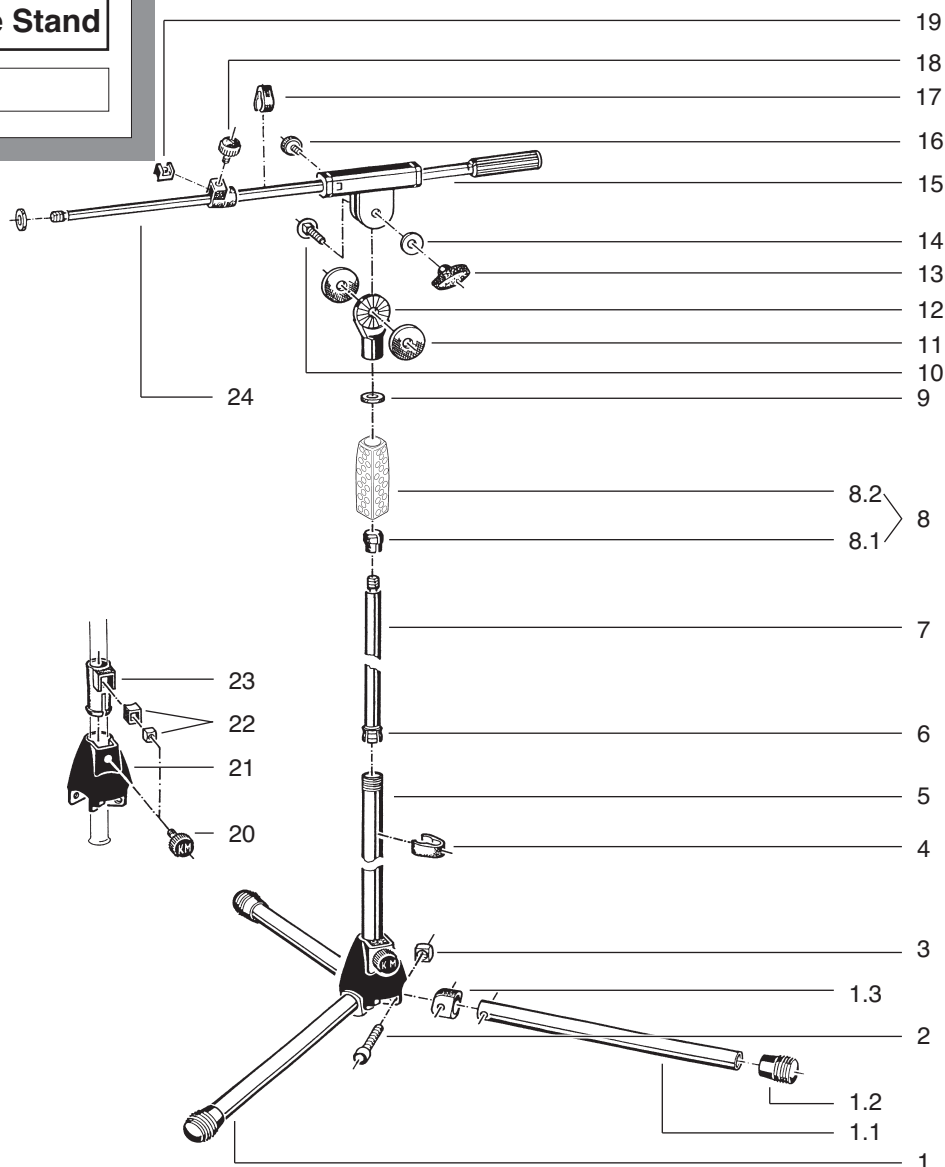

pos.	description	art.-no.	qty
1	leg complete, consisting of:	6.83525.1.87	3
1.1	leg tubing	02.83.525.87	1
1.2	end-caps	01.84.980.55	1
1.3	plastic conector joint	01.87.939.55	1
2	allen screw M5 x 40 mm	03.02.180.29	3
3	locking nut M5	03.08.210.29	3
4	plastic cable holder ø 20 mm	01.85.970.55	1
5	base rod	02.75.420.87	1
6	plastic stop	01.85.070.55	1
7	extension rod complete	7.200.030987	1
8	sleever assmby complete, consisting of:	7.210.600587	1
8.1	plastic ring	01.86.820.55	1
8.2	plastic tightening sleeve	03.22.410.55	1
9	aluminum threaded washer 3/8"	03.31.550.15	2
10	carriage bolt M8 x 30 mm	03.07.530.25	1
11	rubber washer 3 mm	03.21.160.55	2
12	swivel head 3/8"	02.40.430.87	1
13	locking knob	01.83.980.55	1
14	washer ø 8,4 mm	03.11.525.01	1
15	extension tube complete	7.211.400187	1
16	toggle screw M6 x 12 mm with K&M logo	01.82.828.55	1
17	plastic cable holder ø 15 mm	01.85.960.55	1
18	toggle screw M6 x 16 mm	01.82.833.55	1
19	plastic locking spacer	6.86615.1.55	1
20	toggle screw M6 x 22 mm with K&M logo	01.82.838.55	1
21	socket	02.41.080.87	1
22	plastic locking spacer complete	6.86648.1.55	1
23	spacer ring	01.86.540.55	1
24	extension rod complete	7.211.430287	1