

### GENERAL

The Shure A98D mounts Shure BETA 98/S or SM98A microphones on a drum or cymbal. The gooseneck adapter can be inserted into the horizontal or vertical slots of the clamp for optimum flexibility in microphone placement.

### DRUM RIM MOUNTING

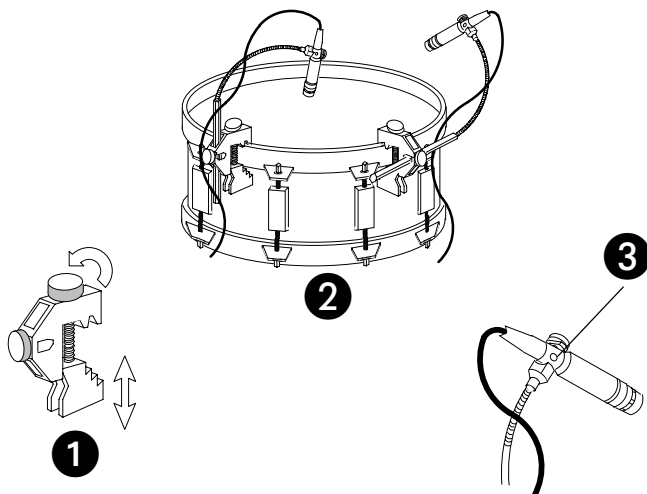

**WARNING:** Do NOT tighten the thumbscrew on the plastic section of the connector as this could cause damage.

**NOTE:** To minimize potential noise or damage, position the microphone outside the drummer's range of stick movement and cymbal movement.

### REPLACEMENT PARTS

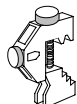

Clamp Assembly ..... RPM618



Jaw ..... 32A866

### CYMBAL STAND MOUNTING

The clamp fits drum rims measuring from 1/2-in. (12.7 mm) to 2 1/4 -in. (57.2 mm) in height, or on cymbal stands measuring from 3/8-in. (9.5 mm) to 1 1/8-in. (28.6 mm) in diameter.

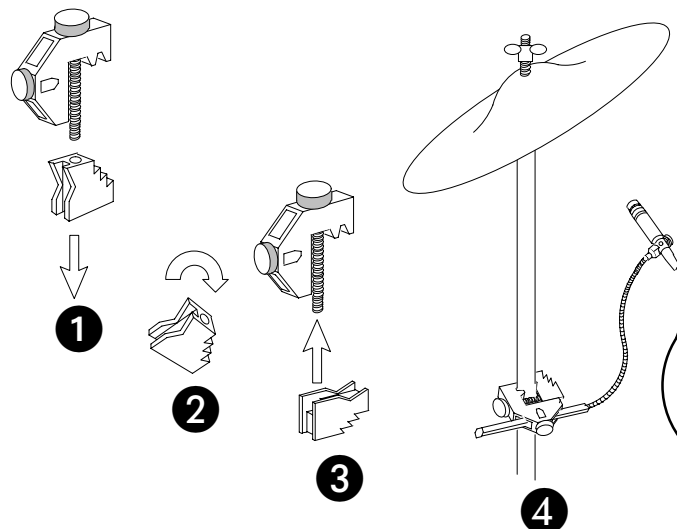

SHURE Incorporated <http://www.shure.com>  
United States, Canada, Latin America, Caribbean:  
5800 W. Touhy Avenue, Niles, IL 60714-4608, U.S.A.  
Phone: 847-600-2000 U.S. Fax: 847-600-1212 Intl Fax: 847-600-6446  
Europe, Middle East, Africa:  
Shure Europe GmbH, Phone: 49-7131-72140 Fax: 49-7131-721414  
Asia, Pacific:  
Shure Asia Limited, Phone: 852-2893-4290 Fax: 852-2893-4055