

# ***MotionDrape***<sup>™</sup> LED

## User Manual

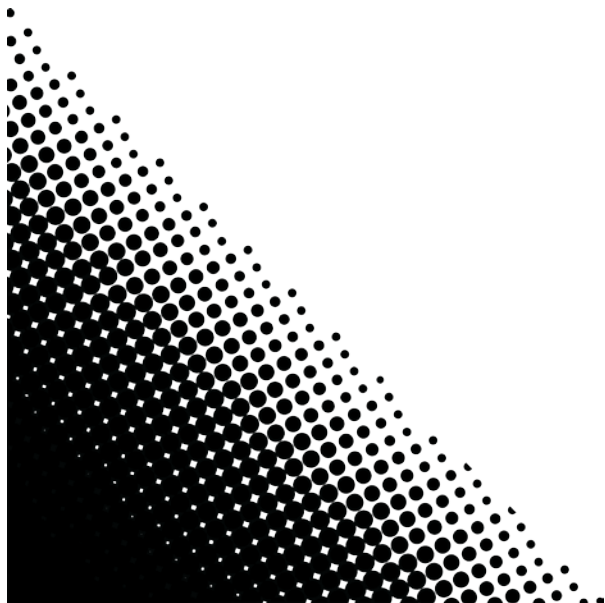
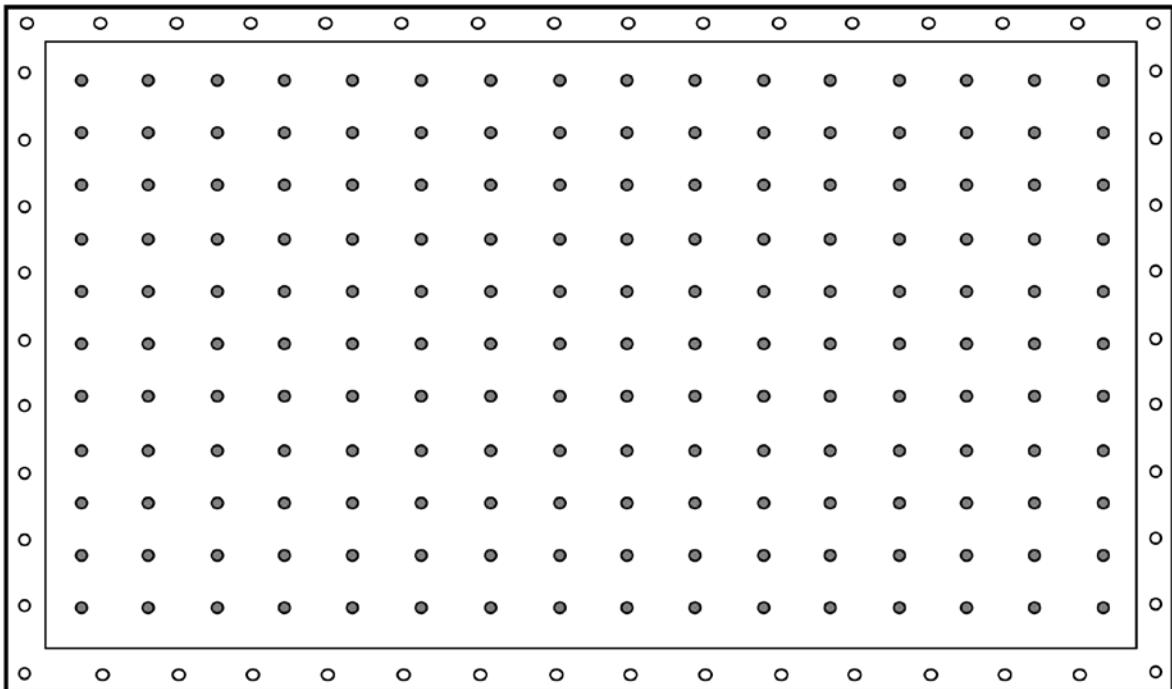

---

# TABLE OF CONTENTS

<b>1. Before You Begin .....</b>	<b>3</b>
What Is Included .....	3
Unpacking Instructions.....	3
<i>Claims</i> .....	3
Text Conventions .....	3
Icons.....	3
Document Information.....	3
Product at a Glance .....	4
Safety Notes.....	4
<b>2. Introduction .....</b>	<b>5</b>
Product Overview.....	5
Product Dimensions .....	5
<b>3. Setup .....</b>	<b>6</b>
AC Power .....	6
<i>Fuse Replacement</i> .....	6
Mounting .....	7
<i>Orientation</i> .....	7
<i>Rigging</i> .....	7
<b>4. Operation .....</b>	<b>8</b>
Control Panel Operation.....	8
Menu Map .....	8
Configuration (DMX) .....	8
<i>Starting Address</i> .....	8
Configuration (Standalone) .....	9
<i>Sound Mode</i> .....	9
<i>Automatic Mode</i> .....	9
<i>Master/Slave Mode</i> .....	9
DMX Channel Assignments and Values .....	10
<i>8-CH</i> .....	10
<b>5. Technical Specifications .....</b>	<b>11</b>
<b>Returns.....</b>	<b>12</b>
<b>Contact Us .....</b>	<b>13</b>

# 1. BEFORE YOU BEGIN

## What Is Included

- MotionDrape™ LED
- MotionDrape™ Controller
- Power Cord
- Signal Cable
- Carrying Bag
- Replacement LEDs
- Reusable Zip Ties (Tie Wraps)
- Warranty Card
- Quick Reference Guide

## Unpacking Instructions

Immediately upon receipt, carefully unpack this product and check the container to make sure you have received all the parts indicated above in good condition.

## Claims



If the box or the contents (this product and any other accessory included) appears damaged from shipping, or shows signs of mishandling, notify the carrier immediately, not Chauvet, upon receipt of the damaged merchandise. Failure to do so in a timely manner may invalidate your claim with the carrier. In addition, retain the container and all the packing material for inspection.

For other issues such as missing components or parts, damage not related to shipping, or concealed damage, file a claim with Chauvet within 7 days of receiving the merchandise.

## Text Conventions

Convention	Meaning
1–512	A range of values
50/60	A set of values of which only one can be chosen
<b>Settings</b>	A menu option not to be modified
<b>Menu &gt; Settings</b>	A sequence of menu options to be followed
<ENTER>	A key to be pressed on the product's control panel
ON	A value to be entered or selected

## Icons

Icon	Meaning
	Critical installation, configuration, or operation information. Failure to comply with this information could cause the product not to work, damage it, or cause harm to the operator.
	Important installation or configuration information. Failure to comply may keep the product from working correctly.
	Useful information.

## Document Information

The information and specifications contained in this document are subject to change without notice. Chauvet assumes no responsibility or liability for any errors or omissions that may appear in this manual. Chauvet reserves the right to update the existing document or to create a new document to correct any errors or omissions.

You can download the latest version of this document from [www.chauvetlighting.com](http://www.chauvetlighting.com).

© Copyright 2014 Chauvet. All rights reserved.

Electronically published by Chauvet in the United States of America.

Author	Date	Editor	Date
A. Leon	11/18/14	M. Trouard	11/18/14

## Product at a Glance

Use on Dimmer	X	Auto Programs	P
Outdoor Use	X	Auto-ranging Power Supply	P
Sound Activated	P	Replaceable Fuse	P
DMX	P	User Serviceable	X
Master/Slave	P	Duty Cycle	X

## Safety Notes

Please read the following Safety Notes carefully before working with this product. They include important safety information about its installation, usage, and maintenance.



- Always connect this product to a grounded circuit to avoid the risk of electrocution.
- Always disconnect this product from the power source before cleaning it or replacing the fuse.
- Avoid direct eye exposure to the light source while the product is on.
- Make sure the power cord is not crimped or damaged.
- Never disconnect this product from power cord by pulling or tugging on the cord.
- Make sure there are no flammable materials close to the unit while operating.
- Do not touch this product's housing when operating because it may be very hot.



- Always make sure that the voltage of the outlet to which you are connecting this product is within the range stated on the decal or rear panel of the product.
- This product is for indoor use only! (IP20) To prevent risk of fire or shock, do not expose this product to rain or moisture.
- Always install this product in a location with adequate ventilation, at least 20 in (50 cm) from adjacent surfaces.
- Be sure that no ventilation slots on the unit's housing are blocked.
- Never connect this product to a dimmer.
- Make sure to replace the fuse with another of the same type and rating.
- Never carry this product from the power cord or any moving part.
- The maximum ambient temperature (Ta) is 104 °F (40 °C). Do not operate this product at higher temperatures.
- In the event of a serious operating problem, stop using the unit immediately.
- Never try to repair this product. Repairs carried out by unskilled people can lead to damage or malfunction. Please contact the nearest authorized technical assistance center.
- To eliminate unnecessary wear and improve its lifespan, during periods of non-use completely disconnect the product from power via breaker or by unplugging it.



- This product is NFPA-certified fire retardant material.



- Keep this User Manual for future consultation. If you sell this product to another user, be sure that they also receive this document.

## 2. INTRODUCTION

### Product Overview

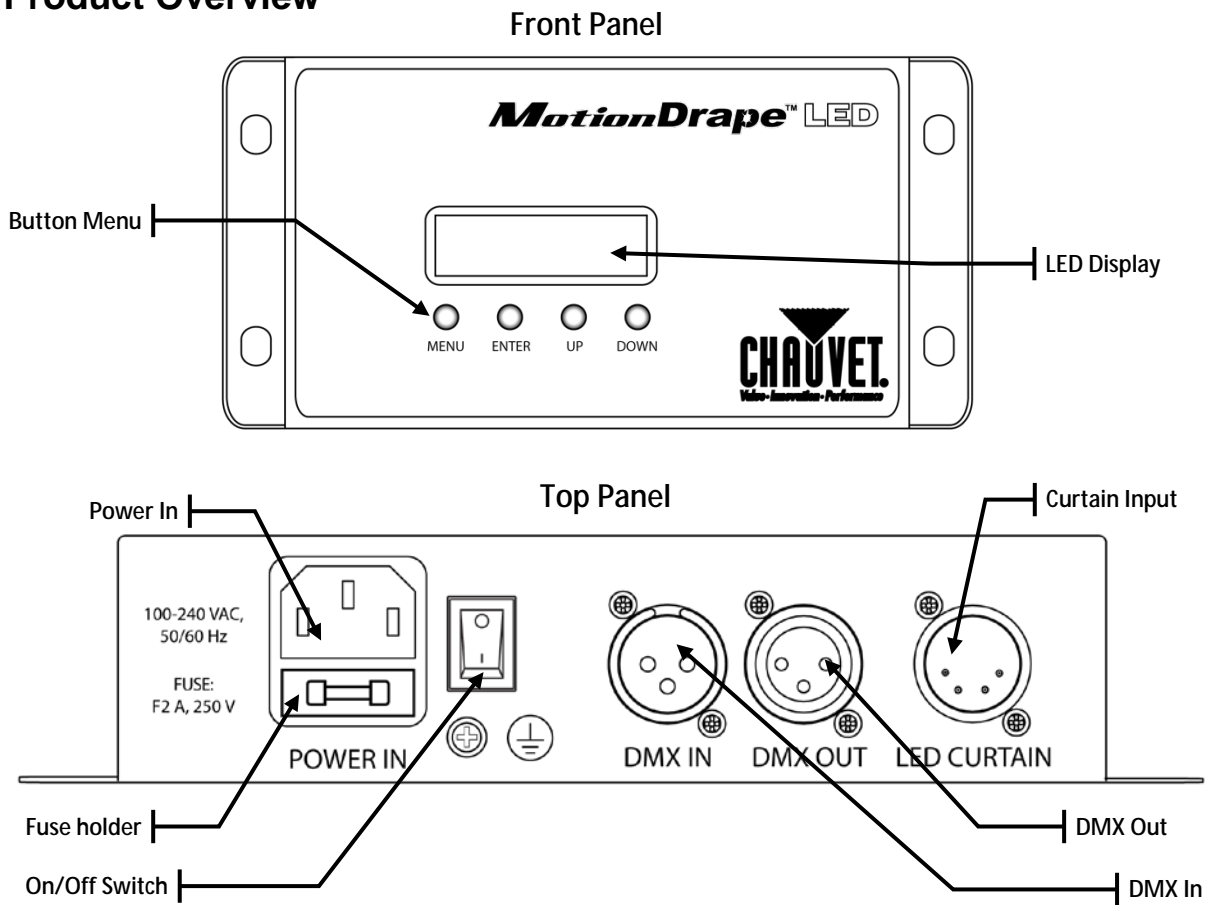

### Product Dimensions

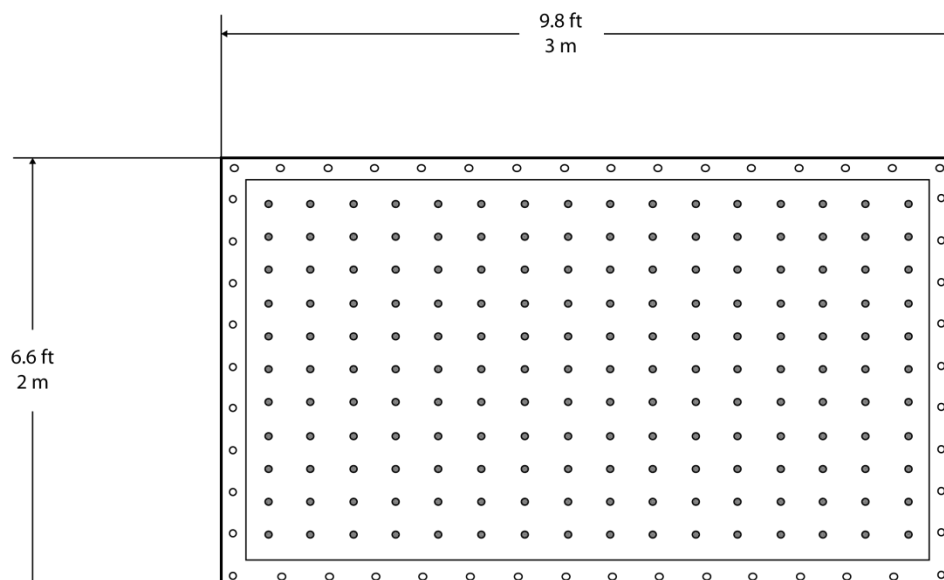

## 3. SETUP

### AC Power

This product has an auto-ranging power supply and can work with an input voltage range of 100 to 240 VAC, 50/60 Hz.

To determine the power requirements for this product (circuit breaker, power outlet, and wiring), use the current value listed on the label affixed to the product's back panel, or refer to the product's specifications chart. The listed current rating indicates the product's average current draw under normal conditions.



**Always connect this product to a protected circuit (circuit breaker or fuse), making sure that it has an appropriate electrical ground to avoid the risk of electrocution or fire.**



**Never connect this product to a rheostat (variable resistor) or dimmer circuit, even if the rheostat or dimmer channel serves only as a 0 to 100% switch.**

### Fuse Replacement

Follow the instructions below to change the fuse, if necessary.



**Disconnect this product from the power outlet before replacing the fuse.**

1. Wedge the tip of a flat head screwdriver into the slot of the fuse holder and pry out of its housing.
2. Remove the blown fuse from its holder and replace with a fuse of the exact same type and rating.
3. Insert the fuse holder back into place, and reconnect power.

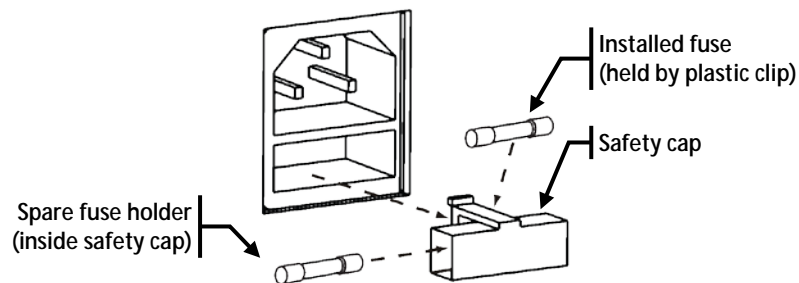

**A spare fuse is not included, but the safety cap does have room for a spare.**



**Always replace a blown fuse with one of the same type and rating.**

---

## Mounting

Before mounting this product, read and follow the [Safety Notes](#).

**Orientation** The MotionDrape™ LED may be mounted in any position; however, make sure adequate ventilation is provided around the product.

**Rigging** Before deciding on a location for this product, always make sure that it will be easy to access the unit for maintenance and programming purposes.

Make sure that the structure onto which you are mounting this product can support its weight. See the [Technical Specifications](#) for weight information.

Mount the product securely to a rigging point, whether an elevated platform or a truss.

Reusable zip ties (tie wraps) are provided with the MotionDrape™ LED for quick and easy mounting.



**This product can be used with the CHAUVET® CH-31 portable truss or any similar portable trussing system.**

Mounting Diagram

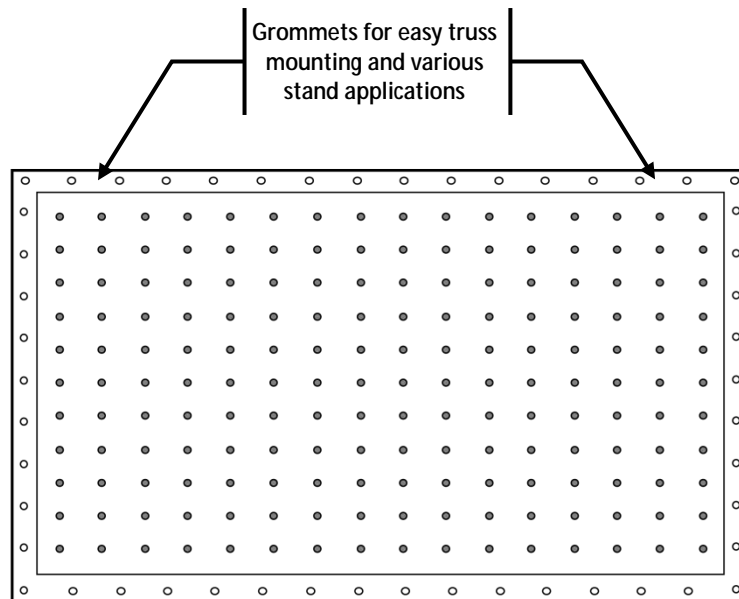

## 4. OPERATION

### Control Panel Operation

To access the control panel functions, use the four buttons located underneath the display. Please refer to the [Product Overview](#) to see the buttons location on the control panel.

Button	Function
<MENU>	Press to find an operation mode or to back out of the current menu option
<ENTER>	Press to activate a menu option or a selected value
<UP>	Press to scroll up the list of options or to find a higher value
<DOWN>	Press to scroll down the list of options or to find a lower value

### Menu Map

Mode	Programming Steps	Description	
Version	VX.X LED-XXX	Shows the software version number	
Automatic	No	Disables automated function	
	Yes	Enables automated function	
Sound	No	Disables Sound mode	
	Yes	Enables Sound mode	
Dmx512	No	Disables DMX512 mode	
	Yes	Address 001–512 Enables DMX512 mode and sets starting address	
Speed	1–9	Selects how fast the automated programs run	
Program	1–30	No	Disables numbered program running in sequence in Automatic or Sound mode
		Yes	Enables numbered program running in sequence in Automatic or Sound mode

### Configuration (DMX)

Set this product in DMX mode to control it with a DMX controller.

1. Connect this product to a suitable power outlet.
2. Turn this product on.
3. Connect a DMX cable from the DMX output of the DMX controller to the DMX input socket of this product.

### Starting Address

When selecting a starting DMX address, always consider the number of DMX channels the selected DMX mode uses. If you choose a starting address that is too high, you could restrict the access to some of the product's channels.

The MotionDrape™ LED uses up to 8 DMX channels in its 8-channel DMX mode, which defines the highest configurable address to **505**.

If you are not familiar with the DMX protocol, download the *DMX Primer* from [www.chauvetlighting.com](http://www.chauvetlighting.com).

To select the starting address, do the following:

1. Press <MENU> repeatedly until **Dmx512** shows on the display.
2. Press <ENTER>.
3. Use <UP> or <DOWN> to select **Yes** in the menu.
4. Press <ENTER>. **Address** should appear on the screen.
5. Use <UP> or <DOWN> to select the starting address.
6. Press <ENTER>.



---

## Configuration (Standalone)

Set this product in one of the standalone modes to control it without a DMX controller.

1. Connect this product to a suitable power outlet.
2. Turn this product on.



**Never connect a product that is operating in any standalone mode, whether Automatic or Sound to a DMX string connected to a DMX controller. This is because products in standalone mode may transmit DMX signals that could interfere with the DMX signals from the controller.**

**Sound Mode** To enable the Sound mode, do the following:

1. Press **<MENU>** repeatedly until **Sound** shows on the display.
2. Press **<ENTER>**.
3. Use **<UP>** or **<DOWN>** to select **Yes**.
4. Press **<ENTER>**.
5. Turn the music on until the product responds to the beat of the music.



**The product will only respond to low frequencies of the music (bass and drums).**

**Automatic Mode** To enable the Automatic Mode, follow the instructions below:

1. Press **<MENU>** repeatedly until **Automatic** shows on the display.
2. Press **<ENTER>**.
3. Use **<UP>** or **<DOWN>** to select **Yes**.
4. Press **<ENTER>**.

## Master/Slave Mode

This mode allows a single unit (the master) to control the actions of one or more units (the slaves) without the need of a DMX controller. The master unit will be set to operate in either Automatic or Sound mode, while the slave units will be set to operate in Slave mode. Once set and connected, the slave units will operate in unison with the master unit.

Configure the units as indicated below.

Slave units:

1. Press **<MENU>** repeatedly until **DMX mode** shows on the display.
2. Press **<ENTER>** to accept.
3. Use **<UP>** or **<DOWN>** to select **Yes**.
4. Press **<ENTER>**.
5. Use **<UP>** or **<DOWN>** to select the starting address to: **d001**.
6. Press **<ENTER>**.
7. Connect the DMX input of the first slave unit to the DMX output of the master unit.
8. Connect the DMX input of the subsequent slave units to the DMX output of the previous slave unit.
9. Finish setting and connecting all the slave units.

Master unit:

1. Set the master unit to operate in either Automatic or Sound mode, as previously indicated.
2. Make the master unit the first unit in the DMX daisy chain.



**Wait until all the slave units are configured and connected before connecting the master unit to the DMX daisy chain.**

**Never connect a DMX controller to a DMX string configured for Master/Slave operation because it may interfere with the signals from the master unit.**



**Do not connect more than 31 slave units to the master unit.**

**The MotionDrape™ and MotionFaçade™ can also be used together in this mode with the same configuration.**

## DMX Channel Assignments and Values

8-CH	Channel	Function	Value	Setting
1	Dimmer		000 ó 007	No function
			008 ó 255	0–100%
2	Strobe		000 ó 010	No function
			011 ó 255	0–100%
3	Red		000 ó 255	0–100%
4	Green		000 ó 255	0–100%
5	Blue		000 ó 255	0–100%
6	Programs 1–15		000 ó 015	No function
			016 ó 031	Falling Star
			032 ó 047	Diagonal Color Bands
			048 ó 063	Color Pattern Chase
			064 ó 079	Inward Arrow (L–R)
			080 ó 095	Color Stack
			096 ó 111	Multi-Color Freeway
			112 ó 127	Color Wave (L–R)
			128 ó 143	Color Wave (R–L)
			144 ó 159	Color Bar Chase (L–R)
			160 ó 175	Color Bar Chase (R–L)
			176 ó 191	Windmill
			192 ó 207	Fan
			208 ó 223	Whirlpool
			224 ó 239	Falling Snow
240 ó 255	Multi Box Frenzy			
7	Programs 16–30		000 ó 015	No function
			016 ó 031	Center Burst
			032 ó 047	Outer Burst
			048 ó 063	EQ Effect
			064 ó 079	Rolling Color
			080 ó 095	Horizontal Stacking
			096 ó 111	Inner Zone
			112 ó 127	Outer Zone
			128 ó 143	Diamond Spread
			144 ó 159	Single Diamond Squeeze
			160 ó 175	Follow The Leader
			176 ó 191	Crisscross
			192 ó 207	X Factor
			208 ó 223	Double Diamond Squeeze
			224 ó 239	Red X Factor
240 ó 255	Multicolor Rain			
8	Speed		000 ó 255	0–100%

## 5. TECHNICAL SPECIFICATIONS

<b>Dimensions and Weight</b>	<b>Length (Drape)</b>	<b>Width (Drape)</b>	<b>Height (Drape)</b>	<b>Weight (Drape)</b>
	9.8 ft (118 in) 3 m (3,000 mm)	0.6 in (15 mm)	6.6 ft (78.7 in) 2 m (2,000 mm)	9.8 lb (4.4 kg)
	<b>Length (Control Box)</b>	<b>Width (Control Box)</b>	<b>Height (Control Box)</b>	<b>Weight (Control Box)</b>
	9.6 in (243 mm)	5.3 in (135 mm)	2 in (50 mm)	1.8 lb (0.8 kg)
<b>Note:</b> Dimensions in inches and feet rounded to the nearest decimal digit.				
<b>Power</b>	<b>Power Supply Type</b>	<b>Range</b>	<b>Voltage Selection</b>	
	Switching (internal)	100 to 240 V, 50/60 Hz	Auto-ranging	
	<b>Parameter</b>	<b>120 V, 60 Hz</b>	<b>230 V, 50 Hz</b>	
	Consumption	51 W	54 W	
	Operating	0.4 A	0.2 A	
	Fuse	F 2 A, 250 V	F 2 A, 250 V	
	<b>Power I/O</b>	<b>US/Worldwide</b>	<b>UK/Europe</b>	
	Power input connector	IEC	IEC	
	Power output connector	Edison	IEC	
	Power Cord plug	Edison (US)	Local plug	
<b>Light Source</b>	<b>Type</b>	<b>Quantity</b>	<b>Lifespan</b>	
	LED	176	50,000 hours	
<b>Thermal</b>	<b>Maximum External Temp.</b>	<b>Cooling System</b>		
	104 °F (40 °C)	Convection		
<b>DMX</b>	<b>I/O Connectors</b>	<b>Connector Type</b>	<b>Channel Range</b>	
	3-pin XLR	Sockets	8	
<b>Ordering</b>	<b>Product Name</b>	<b>Item Code</b>	<b>Item Number</b>	
	MotionDrape™ LED	15090388	MOTIONDRAPELED	



---

# RETURNS

To return a product or request support:

- In the U.S., contact Chauvet World Headquarters (see [Contact Us](#)).
- In the UK or Ireland, contact Chauvet Europe Ltd. (see [Contact Us](#)).
- In Mexico, contact Chauvet Mexico (see [Contact Us](#)).
- In any other country, DO NOT contact Chauvet. Contact your distributor. See [www.chauvetlighting.com](http://www.chauvetlighting.com) for distributors outside the U.S., United Kingdom, Ireland, or Mexico.



**If you live outside the U.S., United Kingdom, Ireland, or Mexico, contact your distributor of record and follow their instructions on how to return Chauvet products to them. Visit our website for contact details.**

Call the corresponding Chauvet Technical Support office and request a Return Merchandise Authorization (RMA) number before shipping the product. Be prepared to provide the model number, serial number, and a brief description of the cause for the return.

You must send the merchandise prepaid, in its original box, and with its original packing and accessories. Chauvet will not issue call tags.

Clearly label the package with the RMA number. Chauvet will refuse any product returned without an RMA number.



**Write the RMA number on a properly affixed label. DO NOT write the RMA number directly on the box.**

Before sending the product, clearly write the following information on a piece of paper and place it inside the box:

- Your name
- Your address
- Your phone number
- RMA number
- A brief description of the problem

Be sure to pack the product properly. Any shipping damage resulting from inadequate packaging will be your responsibility. FedEx packing or double-boxing is recommended.



**Chauvet reserves the right to use its own discretion to repair or replace returned product(s).**

---

# CONTACT Us

## **WORLD HEADQUARTERS - Chauvet**

### **General Information**

Address: 5200 NW 108th Avenue  
Sunrise, FL 33351  
Voice: (954) 577-4455  
Fax: (954) 929-5560  
Toll free: (800) 762-1084

### **Technical Support**

Voice: (954) 577-4455 (Press 4)  
Fax: (954) 756-8015  
Email: [tech@chauvetlighting.com](mailto:tech@chauvetlighting.com)

**World Wide Web** [www.chauvetlighting.com](http://www.chauvetlighting.com)

## **UNITED KINGDOM AND IRELAND - Chauvet Europe Ltd.**

### **General Information**

Address: Unit 1C  
Brookhill Road Industrial Estate  
Pinxton, Nottingham, UK  
NG16 6NT  
Voice: +44 (0)1773 511115  
Fax: +44 (0)1773 511110

### **Technical Support**

Email: [uktech@chauvetlighting.com](mailto:uktech@chauvetlighting.com)

**World Wide Web** [www.chauvetlighting.co.uk](http://www.chauvetlighting.co.uk)

## **MEXICO - Chauvet Mexico**

### **General Information**

Address: Av. Santa Ana 30  
Parque Industrial Lerma  
Lerma, Mexico C.P. 52000  
Voice: +52 (728) 285-5000

### **Technical Support**

Email: [servicio@chauvet.com.mx](mailto:servicio@chauvet.com.mx)

**World Wide Web** [www.chauvet.com.mx](http://www.chauvet.com.mx)

Outside the U.S., United Kingdom, Ireland, or Mexico, contact your dealer. Follow their instructions to request support or to return a product. Visit our website for contact details.