

E-200 Series INTERCOM SYSTEMS

PRELIMINARY INFORMATION



EB-200

BLUETOOTH BASE STATION
FOR INTERCOM SYSTEMS

- * CLASS 1 BLUETOOTH DEVICE
- * HFP AND HFP-AG BLUETOOTH PROFILES
- * DIRECT CONNECTION TO ALTAIR E-200 LINES
- * POWERED BY THE INTERCOM LINE
- * MAXIMUM RADIO LINKS: ONE HEADSET PER BASE
- * THEORETICAL RANGE: 100 METER MAX.
- * MAXIMUM NUMBER OF BASES PER AREA:
DEPENDS ON TRAFFIC, TYPICAL 20 UNITS

Altair introduces the new *Bluetooth* EB-200 base station compatible with the Altair E-200 cable based intercom systems. This new first on the market station allows the operation of *Bluetooth* devices into the intercom lines. Connection and operation are the same as a beltpack, just connect to the line and go.

The device can be used in two different operation modes:

Headset Mode: Intercom signal is received and transmitted in full duplex mode to any *Bluetooth* compatible headset/handsfree.

Interface Mode: Intercom signal is received and transmitted in full duplex mode to any *Bluetooth* compatible gateway device.

This mode allows, i.e. a mobile phone conversation to be interfaced into the intercom line.

Mic level and ear level can be independent adjusted to meet a broad range of devices' operation.

Pairing is easily set-up by just the pushing of a button.

Applications include wireless replacement of a wired beltpack and headset, telephone interface from mobile phone calls, small wireless intercom systems among others.

Operating range of the system depends of the headset device used or power class chosen.

In order to obtain the best performance, we recommend the use of class 1 devices, allowing a line of sight operation of 60 to 100 meter. When using standard low cost headsets, class 2 devices, the range will be reduced to 10 meters, but this would be enough for close communication as for example the operating room in technical desk operators.

Another benefit of the system is the freedom to receive an external call from your mobile phone in the same headset and the possibility to wear the mixer headphones over the *bluetooth* headset.

APPLICATIONS

- ✧ Single point Wireless headset connection
- ✧ Intercom interface to a handsfree (car) *bluetooth* device
- ✧ Mobile Phone Call interface to intercom systems
- ✧ Short range wireless intercom networks
- ✧ Bluetooth linking of two cable based intercom networks
- ✧ Branch expansions in the Altair WB-200 wireless intercom



The *Bluetooth* trademark and logo are registered trademarks and are owned by the Bluetooth SIG, Inc



EQUIPOS EUROPEOS ELECTRONICOS

Avda. Industria, 50. Tres Cantos. Madrid www.altairaudio.com



E-200 Series INTERCOM SYSTEMS

EB-200
Rear Panel

EB-200 WIRELESS HEADSET LINK WIRED INTERCOM SYSTEM. APPLICATION EXAMPLE

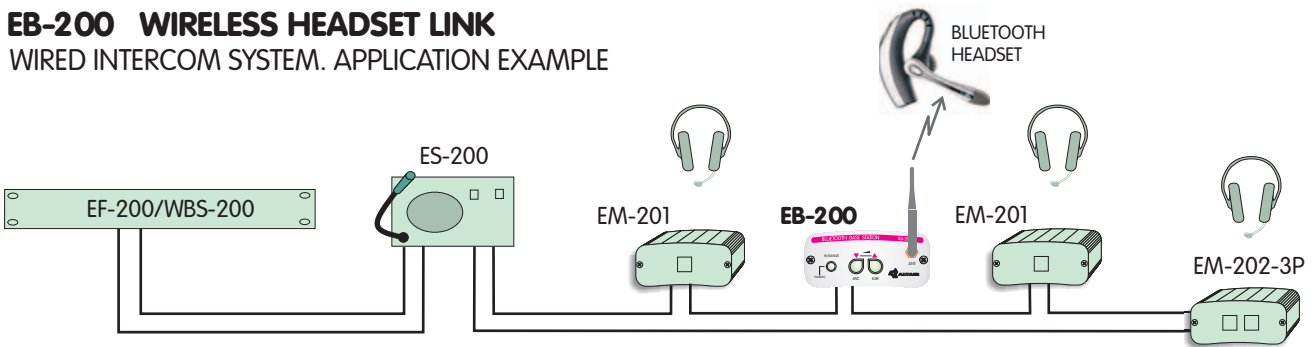

EB-200 WIRELESS HANDSFREE LINK WIRED INTERCOM SYSTEM. APPLICATION EXAMPLE

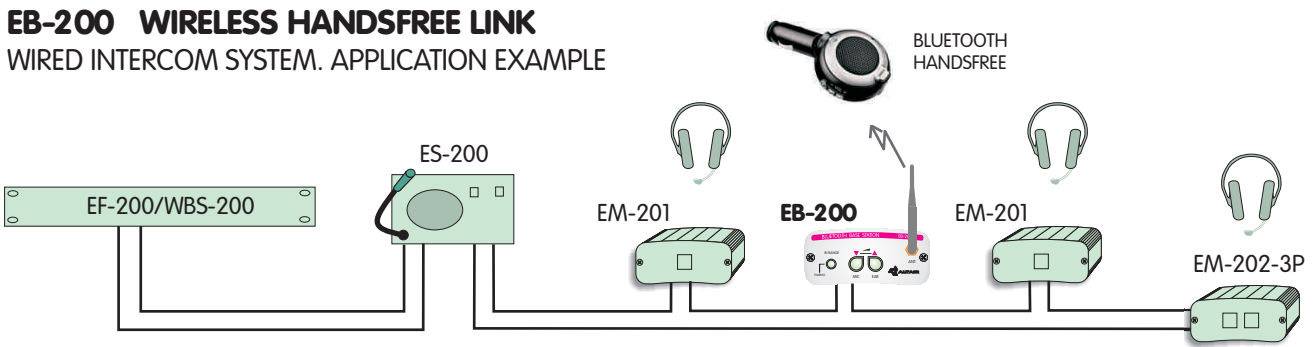

EB-200 INTERFACE MODE WIRED INTERCOM SYSTEM. APPLICATION EXAMPLE

